

Maintaining Water Supply Mop Kits

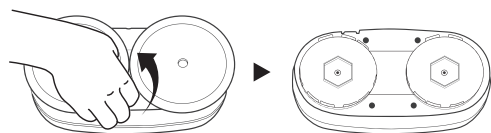

- 1 Separate the mop from the water tank mop kit after finished operating.
 - Please just pull out the water tank mop kit by hands.
 - If it is hard to pull out, please twist it a little bit.

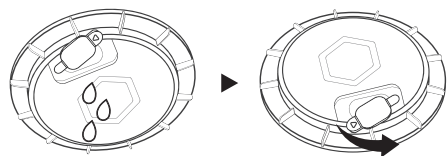

- 2 Open the rubber cap to dry out inside of water tank after pour remained water.

This is Not a Malfunction. Please Check.

LED lamp is OFF

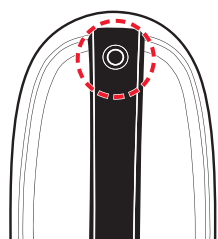

● LED OFF

- If the machine does not work for 5min. It automatically power off together with LED lamp.

● LED ON

- If you press a operation button for 2sec. LED lamp will be turned on with power on status.

Sound alarm while its operation.

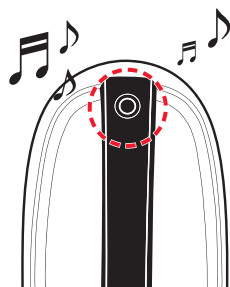

● Blue Blinks

- After 50minute cleaning, the main unit sounds the alarm to change mops and fill water in the water supply mop kit.
- For the better cleaning, replace with new mops and fill water after charging.

Ver 1.0 Copyright © 2019 Everybot Inc. All rights reserved

EVERYBOT EDGE QUICK GUIDE

Please carefully review this guide before using the product
www.everybotweb.com

Components



Main Unit

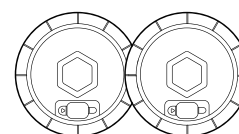

Water Supply Mop Kit

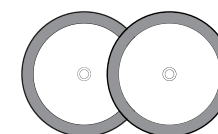

Mother Yarn Mops: Grey

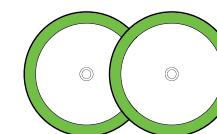

Microfiber Mops: Green

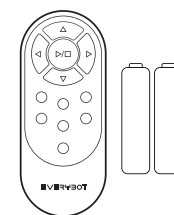

Remote Control:
with Battery

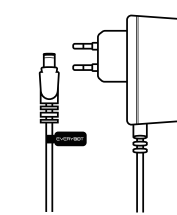

Power Adaptor

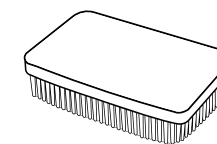

Silicon Brush

Note

· Mother yarn mop (grey color)

It is included with mother yarn which is 100times thicker than microfiber. Thus, it is good for cleaning up dust in cracks and stains.

· Microfiber yarn mop (green color)

It is a mop with richer and longer yarns so it has superior wiping performance.

How to use & Charge



- Please charge the product fully before the first operation.
- When charging the battery, the button on the main unit and the remote control does not work.
- Do not use any other power adapter other than the adapter which came with the unit.

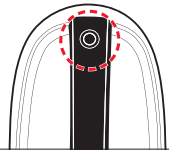
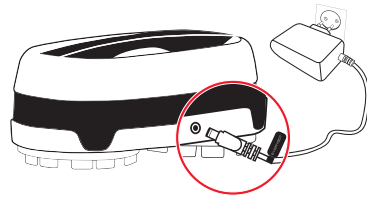

 **Yellow LED Blinks**
Low Battery Level

 **Blue LED Blinks**
Medium Battery Level

 **LED is OFF**
Full Battery

- 1 Wet mops thoroughly in water and apply them in the main unit after wringing them out.
- 2 Attach the mop pads to fit the joint parts to the holes of the water supply mop kit.
- 3 Open the rubber cap of the water supply mop kit and fill the water into the water tank.

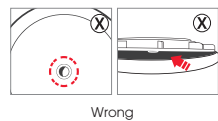
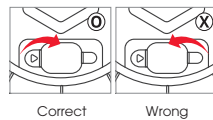
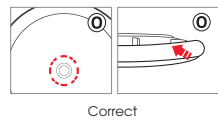
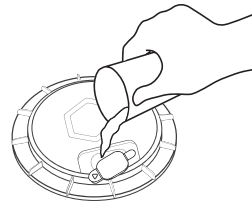
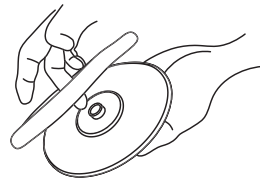
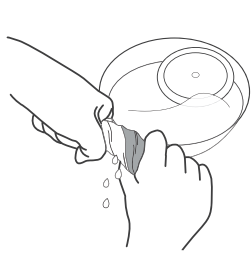

- 4 Close the rubber cap of the water supply mop kit and attach the water supply mop kit into the bottom of the main unit. Pressing it while turning side to side will install it with a click sound.
- 5 Press the operation button more than 2sec. to turn on the main unit.
- 6 Press the operation button on the main unit or play button of a remote control to start the machine.

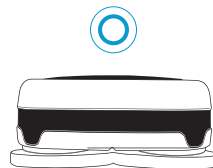
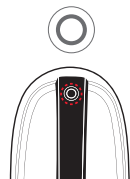
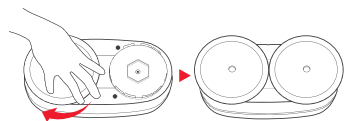

Cleaning Modes



Auto Cleaning

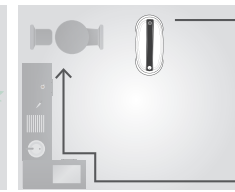

Edge Cleaning

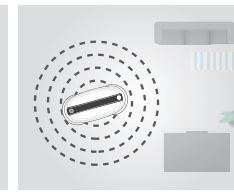

Focus Cleaning

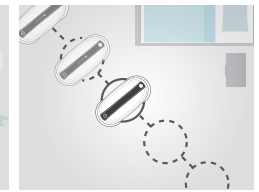

Intensive Cleaning

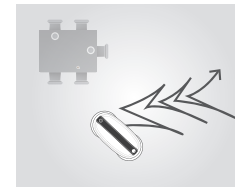

'Y' Cleaning

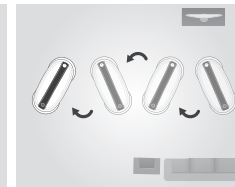

Step Cleaning

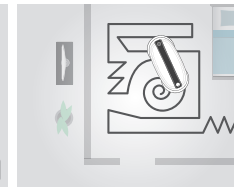

50min. Cleaning



Manual Cleaning

Cautions when using the product

Do not use unauthorized adaptors.

* It may cause serious damage for the product.

Please wash the mops with detergent before of first using.

* Otherwise there could be tainted problem.

Please separate the mop from the water tank mop kit after finished operating.

* If the wet mops stay long time on the floor, the floor may be discolored or polluted.

