

**8** LEDs

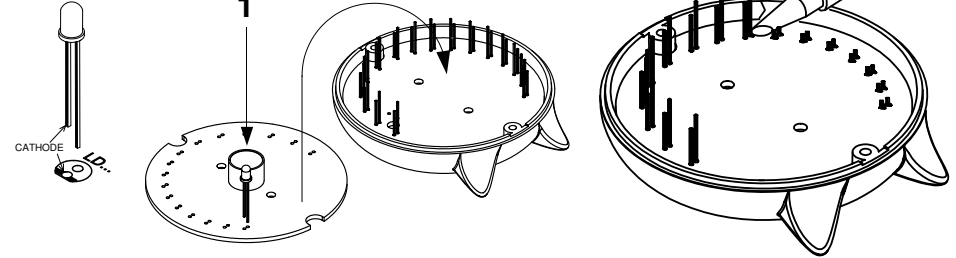

**START**

**1**

**Resistor - Weerstand - Résistance - Widerstand - Resistencia - Motstand - Vastus - Resistenze**

- ◇ R1: 47K (Yellow, Purple, Orange) -(Geel, Paars, Oranje) -(Jaune, Violet, Orange) -(Gelb, Violet, Orange) -(Gul, Lila, Orange) -(Keltainen, Purppura, Oranssi) -(Amarillo, Morado, Naranja) -(Amarelo, Violeta, Laranja) -(Giallo, Viola, Aranciato)
- ◇ R2, R3, R4, R5, R6 : 330 (Orange, Orange, Brown) -(Oranje, Oranje, Bruin) -(Orange, Orange, Brun) -(Orange, Orange, Braun) -(Orange, Orange, Brun) -(Oranssi, Oranssi, Ruskea) -(Naranja) -(Naranja, Marrón) -(Laranja, Laranja, Castanho) -(Aranciato, Aranciato, Marrone)
- ◇ R7, R8 : 0 (Black) -(zwart) -(noir) -(Schwarz) -(Svart) -(Musta) -(Negro) -(Preto) -(Nero)

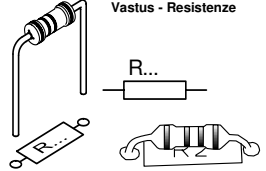

**2**

IC

**Watch the position of the notch !**  
**Attention à la position de l'encoche !**

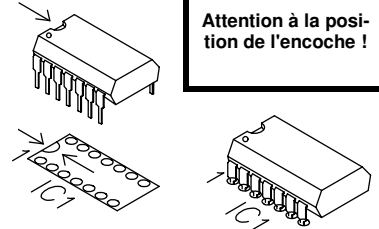

**3**

CAPACITOR

C...

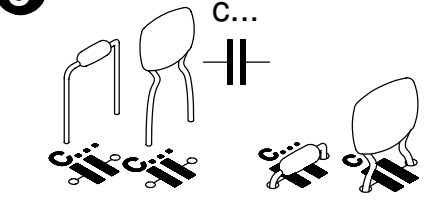

◇ C1 : 100nF (104) µ1

**4**

**ELECTROLYTIC CAPACITOR**

Watch the polarity !  
Att. à la polarité !

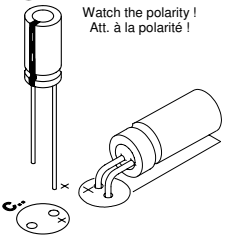

◇ C2: 47µF

**5**

**PUSHBUTTON**

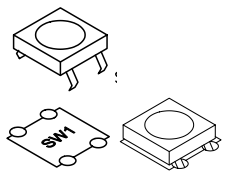

◇ SW1

**6**

**TRANSISTOR**

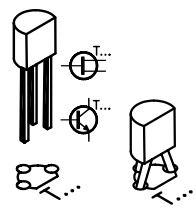

◇ T1 : BC547

**7**

**BUZZER**

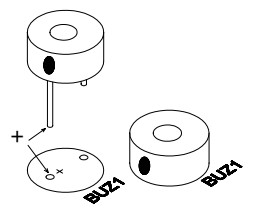

◇ BUZ1

**9**

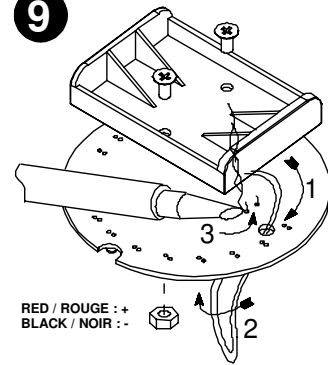

RED / ROUGE : +  
BLACK / NOIR : -

**10**

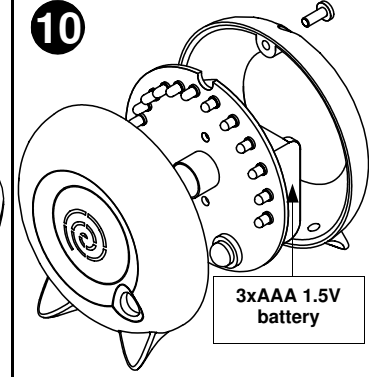

3xAAA 1.5V battery

**DIAGRAM**

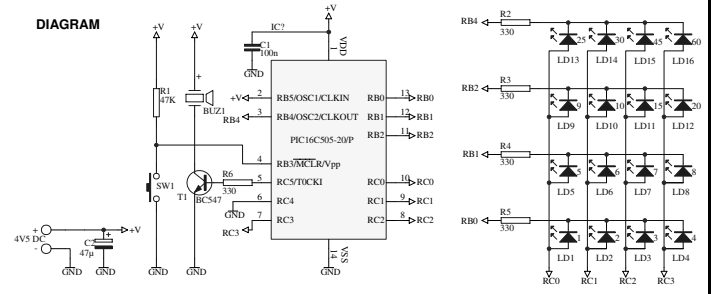

1 2 3 4 5 6 7 8 9 10 11 12 13 14 15 16  
1' 2' 3' 4' 5' 6' 7' 8' 9' 10' 15' 20' 25' 30' 45' 60'



**STOP**