

# TITAN TANK

THE INFRARED REMOTE CONTROL KIT

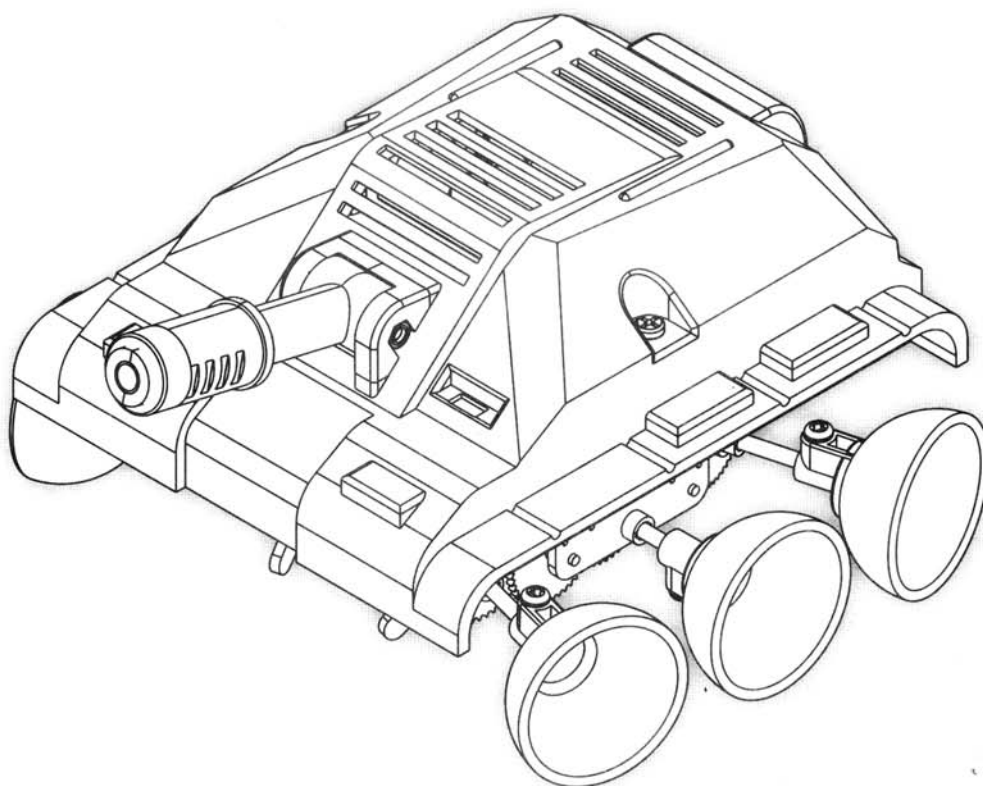

Assembly and Instruction Manual

# Contents

---

## **Multi-Channel I/R Remote Control Box:**

1. Product Introduction .....	P.1
2. Tools You May Need .....	P.1
3. Mechanical Parts List .....	P.1
4. Plastic Parts .....	P.2
5. Mechanical Assembly .....	P.2

## **Titan Tank:**

1. Product Introduction .....	P.5
2. Tools You May Need .....	P.5
3. Mechanical Parts List .....	P.5
4. Plastic Parts .....	P.6
5. Mechanical Assembly .....	P.7
6. Decoration .....	P.13

<b>How it works</b> .....	R.13
---------------------------	------

<b>Trouble Shooting</b> .....	P.13
-------------------------------	------

<b>Circuit Diagram</b> .....	P.14
------------------------------	------

---

# Multi-channel I/R Remote Control Box

## 1. Product Introduction:



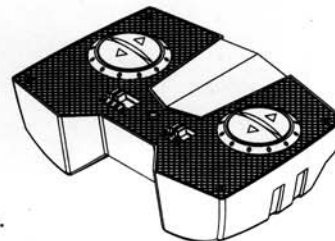

- a) It is four channels I/R remote control box.  
Set up the different channels by switching the left-hand slide switch.
- b) By using infrared, the unit can control 2 motors to turn forward and backward.
- c) Four teams can play together by setting different channels.



### Power source required:

Voltage / Electrical / Mechanical: 1.5V "AA" x4 batteries ( not included )

## 2. Tools You May Need:

Long Nose Pliers	Diagonal Cutter	Screwdriver	AA Battery (4pcs)
			

## 3. Mechanical Parts List:

<b>P1</b>	<b>Battery terminal-1</b>		Qty	2 pcs
-----------	---------------------------	---	-----	-------

<b>P2</b>	<b>Battery terminal-2</b>		Qty	2 pcs
-----------	---------------------------	---	-----	-------

<b>P3</b>	<b>Battery terminal-3</b>		Qty	2 pcs
-----------	---------------------------	---	-----	-------

<b>P4</b>	<b>Tapping screw</b>		Qty	4 pcs (2.3x7)
-----------	----------------------	---	-----	------------------

<b>P5</b>	<b>Tapping screw</b>		Qty	4 pcs (2.6x7)
-----------	----------------------	---	-----	------------------

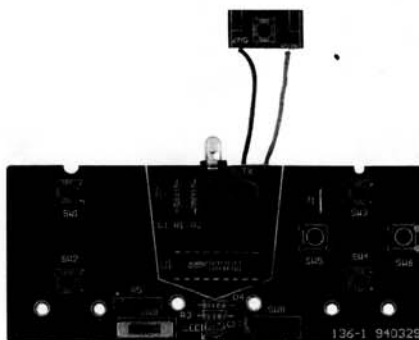
<b>P6</b>	<b>Finished PCB</b>			
				

#### 4. Plastic Parts:

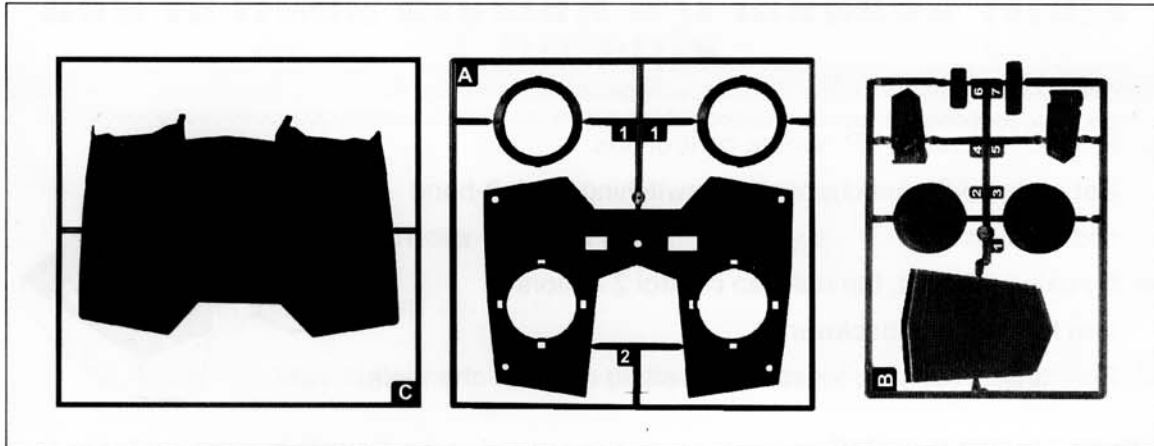

#### 5. Mechanical Assembly:

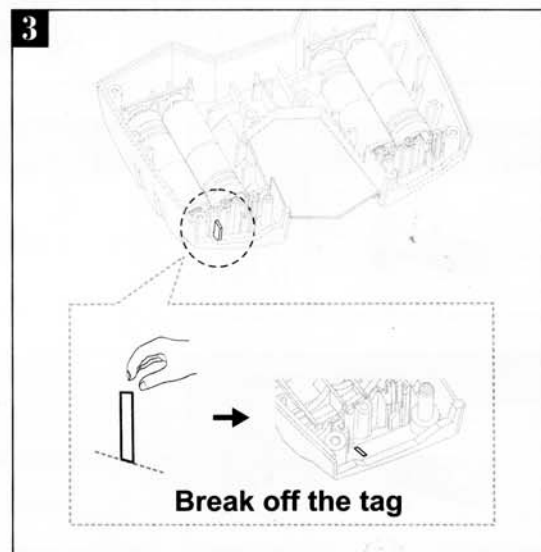
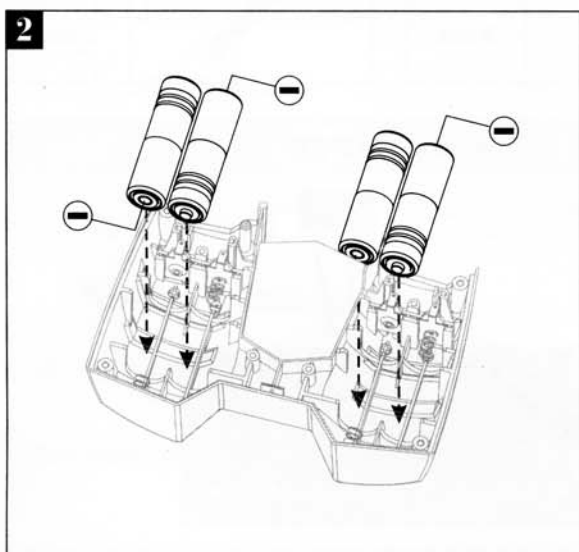
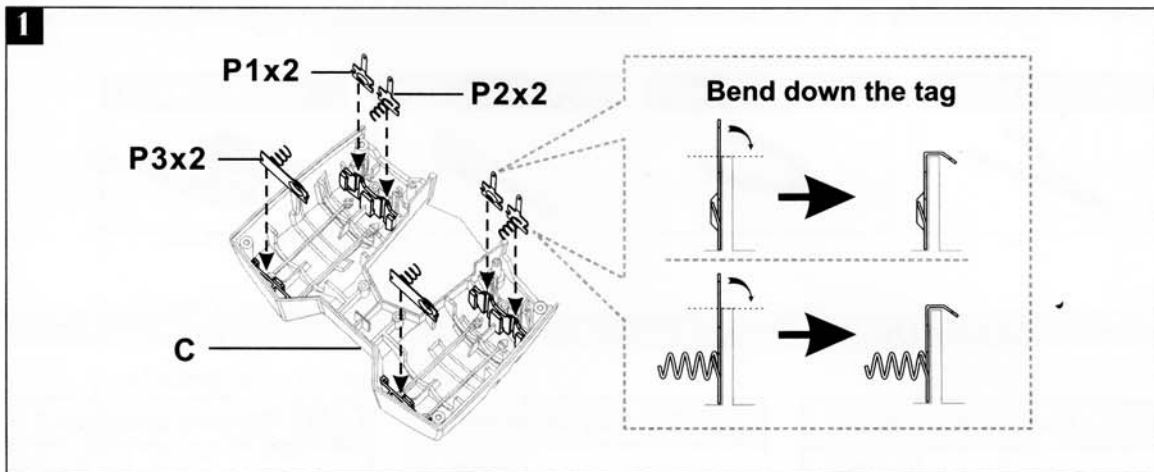

4

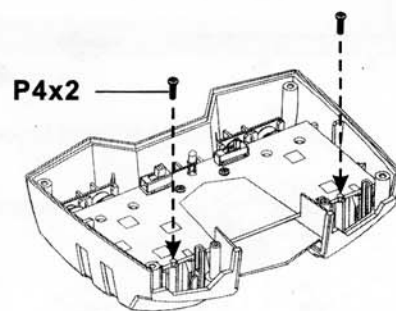
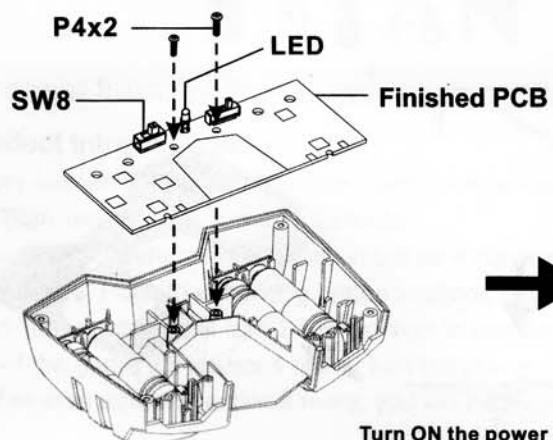

Turn ON the power switch (SW8 to right position), uses 4pcs P4 to screw the PC board tightly until the red LED become to light.

5

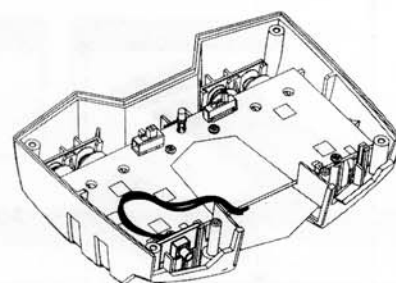
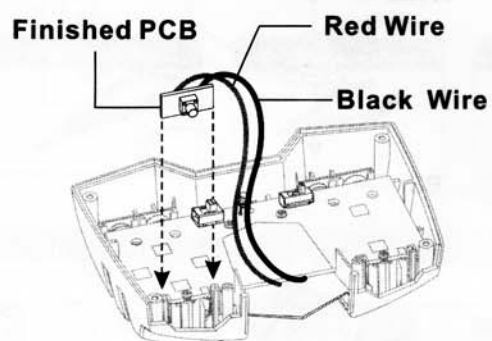

6

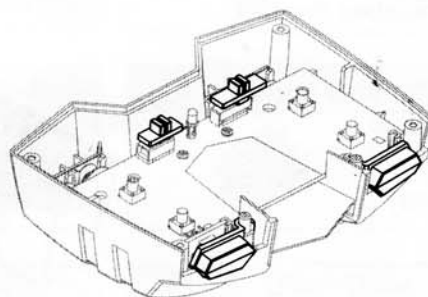
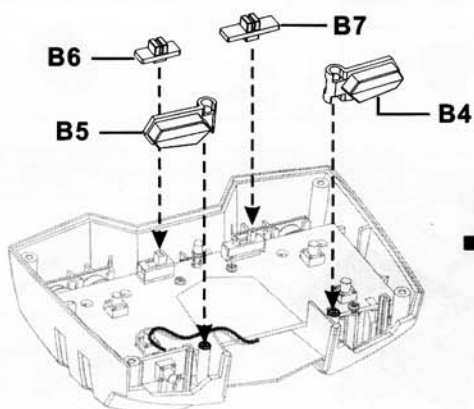

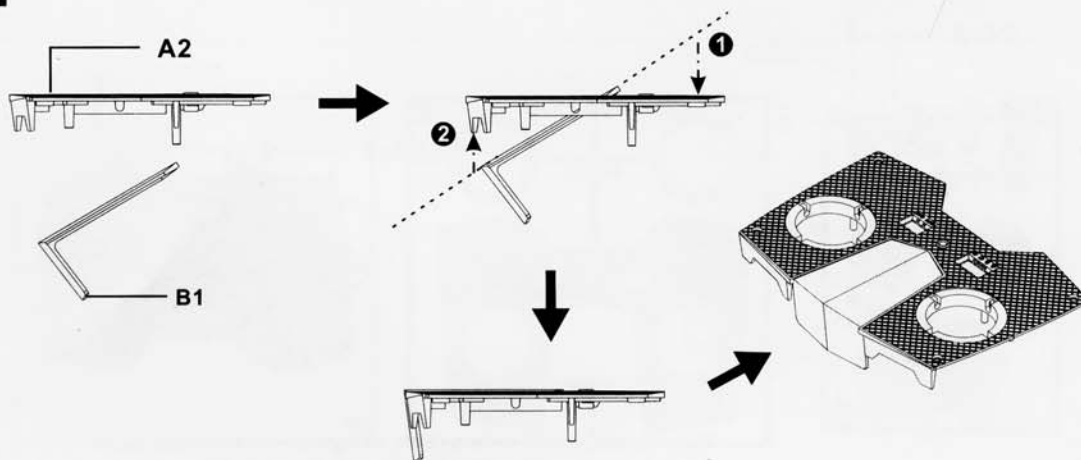
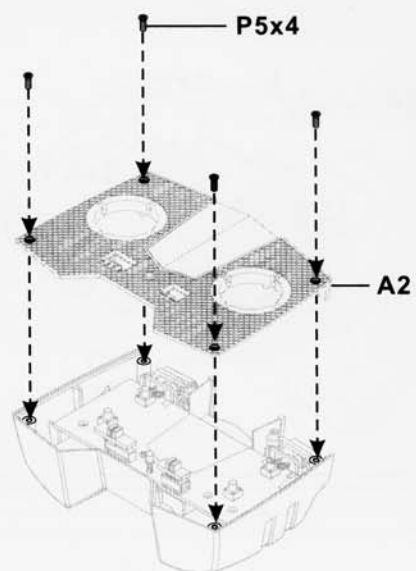
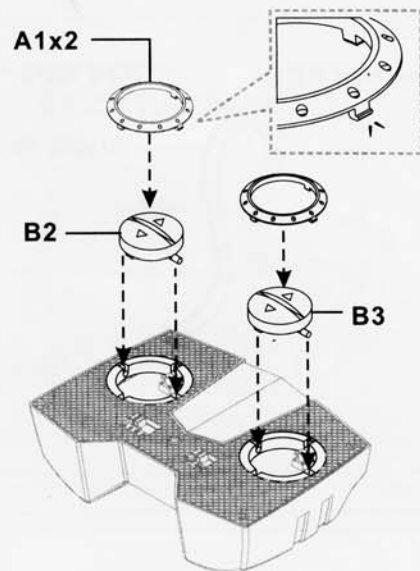
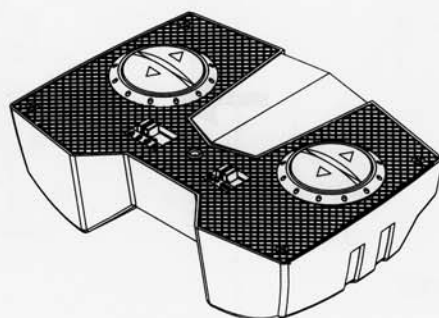
**7****8****9****10** Finished Product

# TITAN TANK

## 1. Product Introduction:

### Product Introduction:

A very interesting Infrared Remote Control Kit, using the control buttons to make the Titan Tank moves, turns and shoots.

Select the different channels (maximum for 4 players) to combat with others. Push the shooting button to shoot, once Titan Tank is shot it will turn 2 circles, then to combat again. Out of the game if it is shot 4 times, turn the power off and re-start again. Practice it more, you will be the winner.

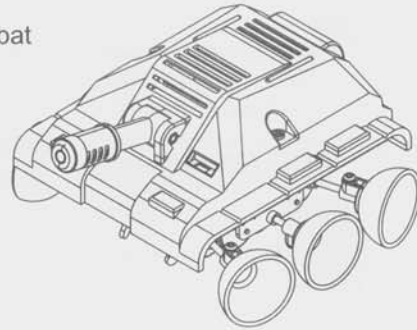

### Power source required:

1.5V "AAA" batteries x 4 pcs ( not included )

## 2. Tools You May Need:

Long Nose Pliers



Diagonal Cutter



Screwdriver



AAA Battery (4pcs)



## 3. Mechanical Parts List:

P1	Motor	Qty
		2 pcs

P2	Motor Holder	Qty
		2 pcs

P3	Screw	Qty
		4 pcs (2x10mm)

P4	Nut	Qty
		4 pcs (M2)

P5	Tapping Screw	Qty
		28 pcs (3x7mm)

P6	Eyelet	Qty
		6 pcs

P7	Gear(44T+0) With Shaft	Qty
		2 pcs (Green)

P8	Gear(44T+0) With Shaft	Qty
		4 pcs (Orange)

P9	Pinion Gear 8T	Qty
		2 pcs (White)

P10	Gear 44/18T	Qty
		4 pcs (Blue)

P11	Gear 48/18T	Qty
		2 pcs (White)

P12	Clear Tube	Qty
		2 pcs

P13	Battery Holder
	Qty
	1 pc

P14	Hex Post
	Qty
	4 pcs

P15	Tapping Screw
	Qty
	2 pcs (3x6mm)

P16	Tapping Screw
	Qty
	6 pcs (3x5mm)

P17	Tapping Screw
	Qty
	1 pc (3x22mm)

P18	Nylon Nut
	Qty
	1 pc (M3)

P19	PCB Assembly
	Qty
	1 pc

P20	Infrared Transmitting Module
	Qty
	1 pc

P21	Buzzer
	Qty
	1 pc

P22	Sponge
	Qty
	1 pc

P23	Black PCV Holder
	Qty
	1 pc

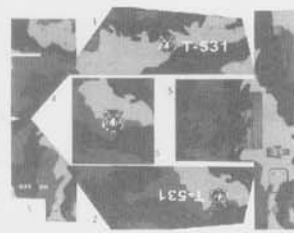
P24	Sticker
	Qty
	6 pcs

#### 4. Plastic Parts:

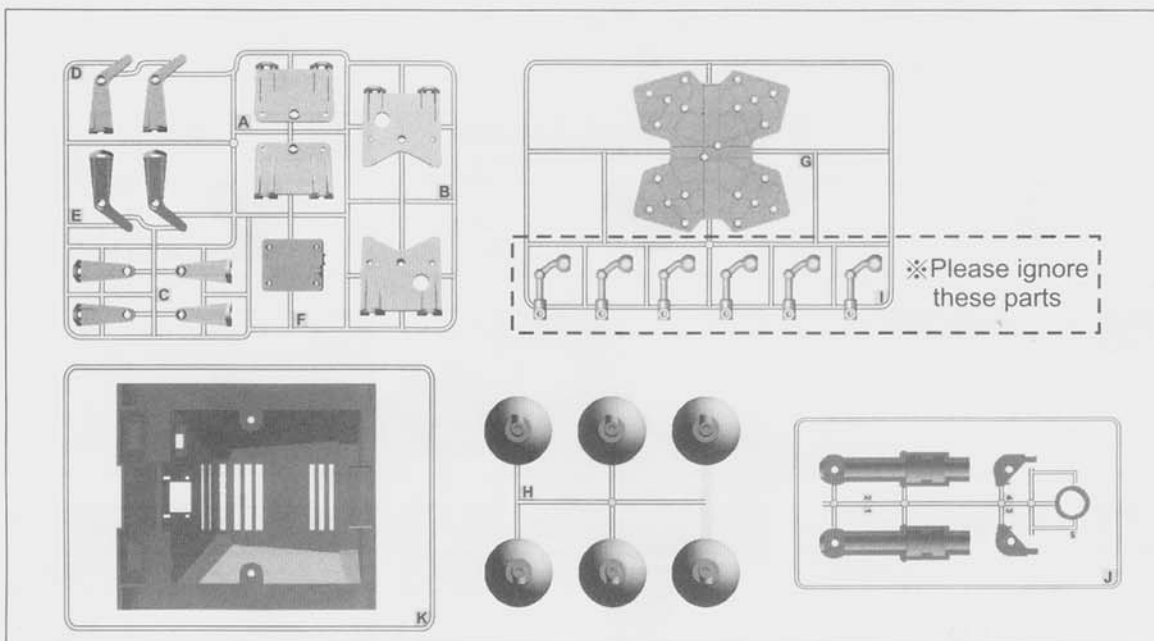



## 5. Mechanical Assembly:

1

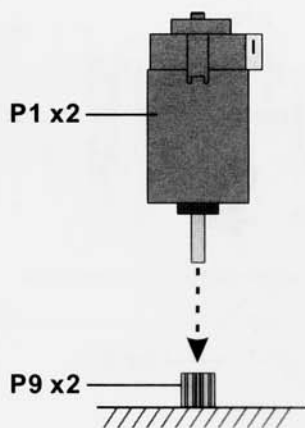

2

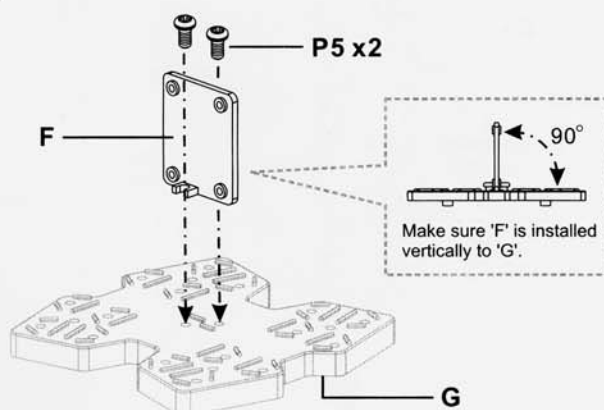

3

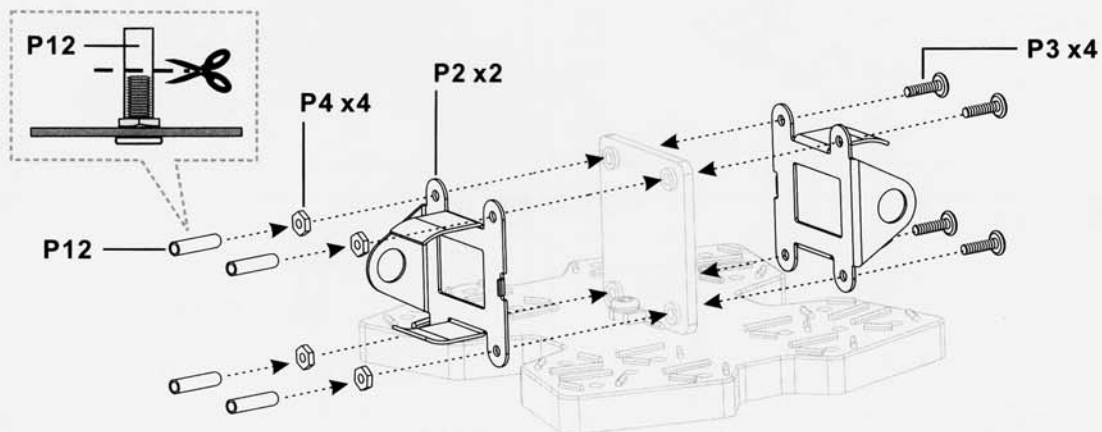

4

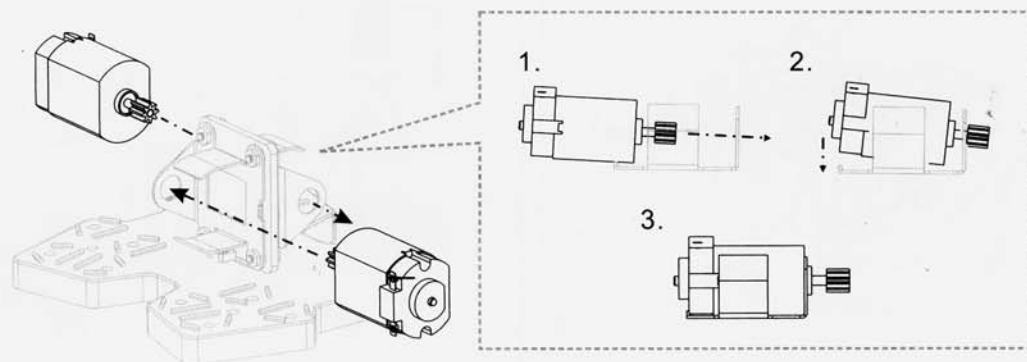

5

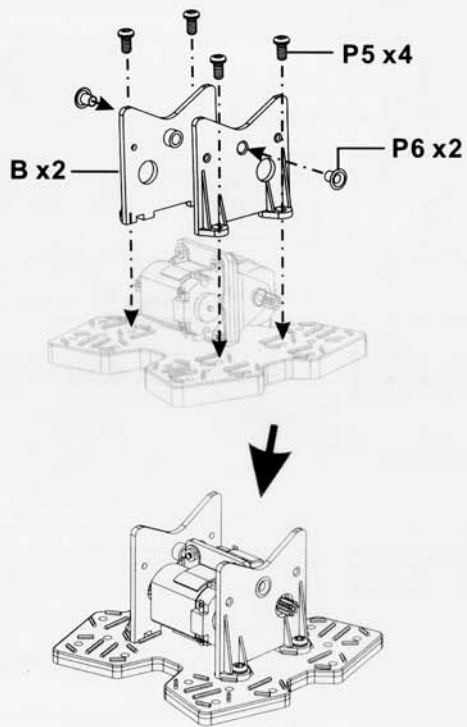

6

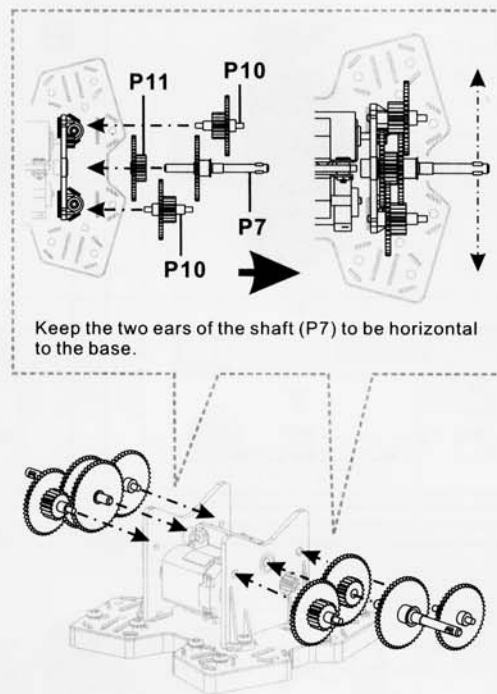

7

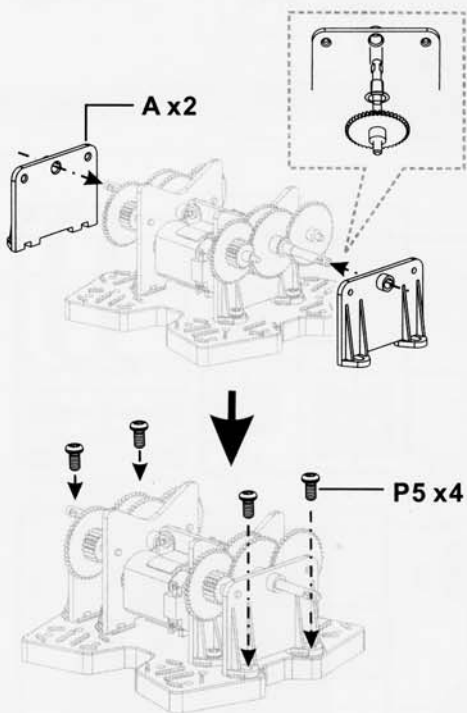

8

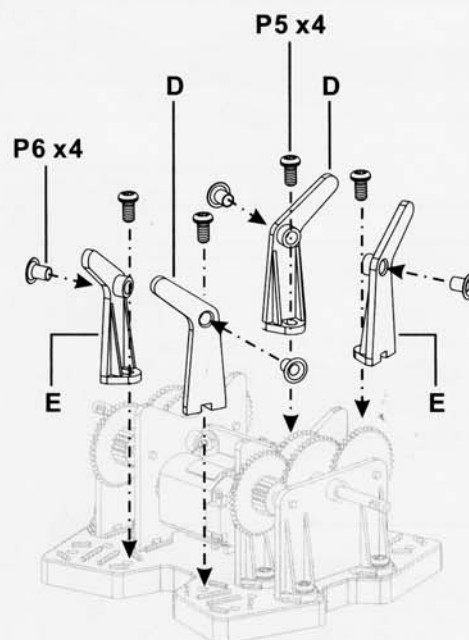

9

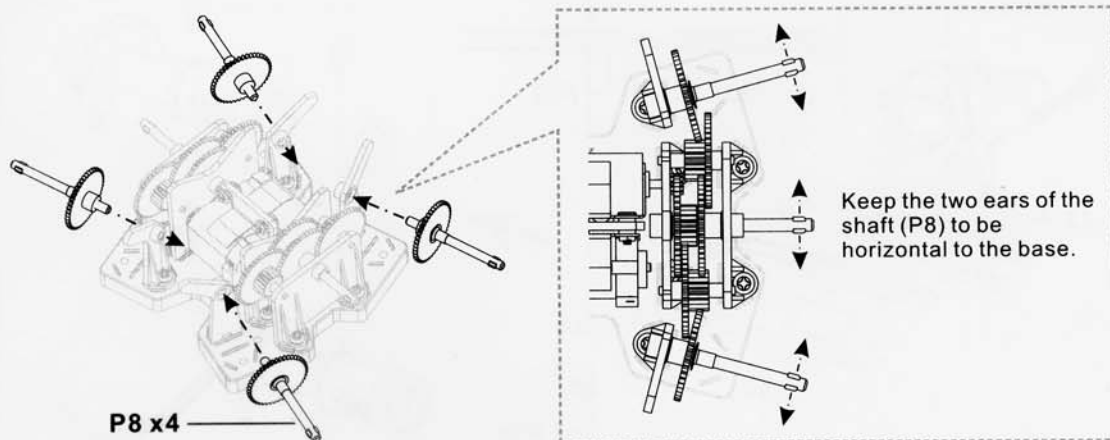

10

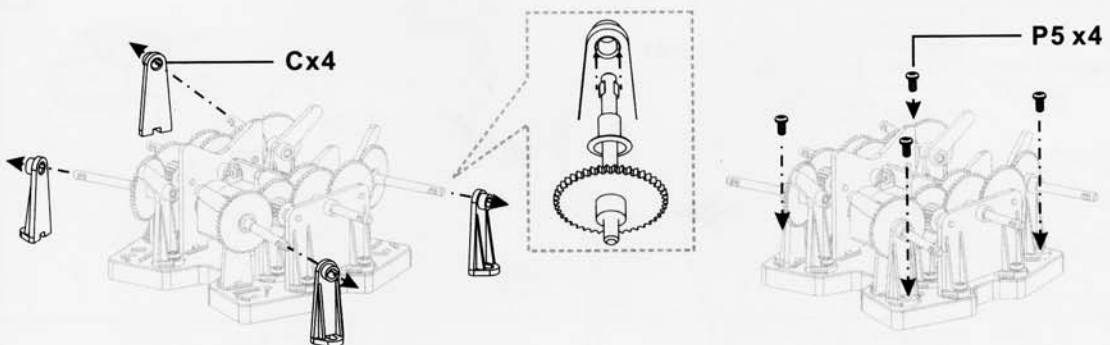

11

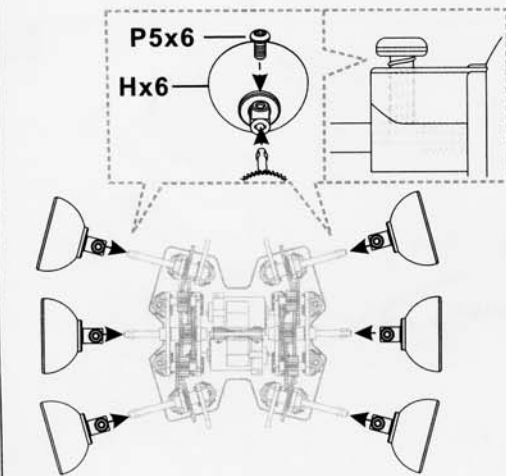

12 Finished Product

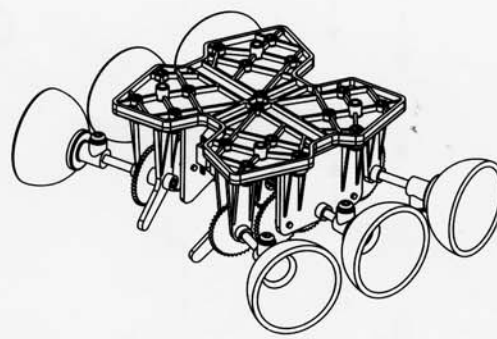

13

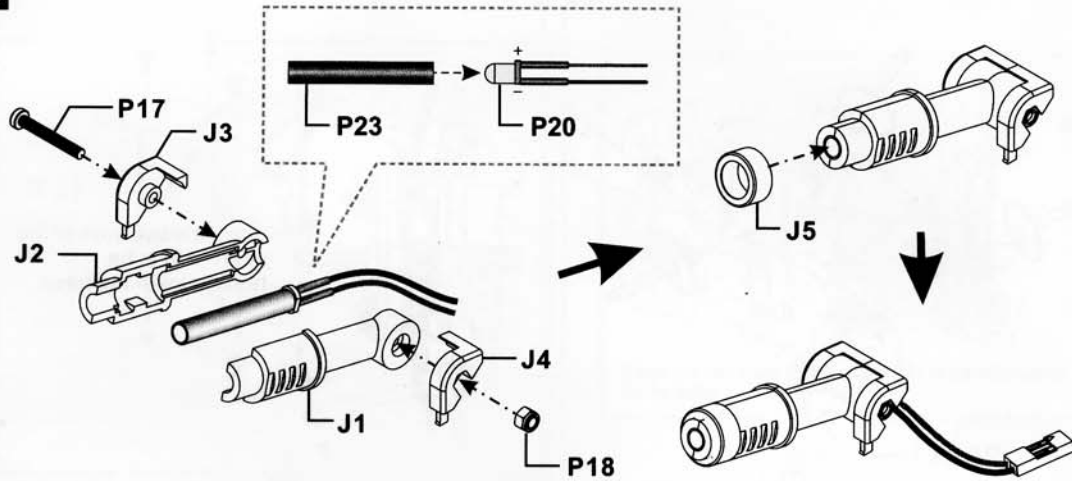

14

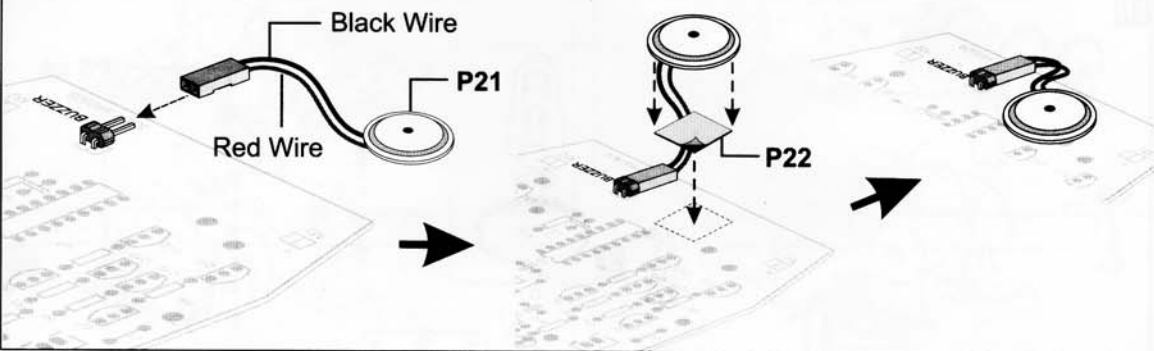

15

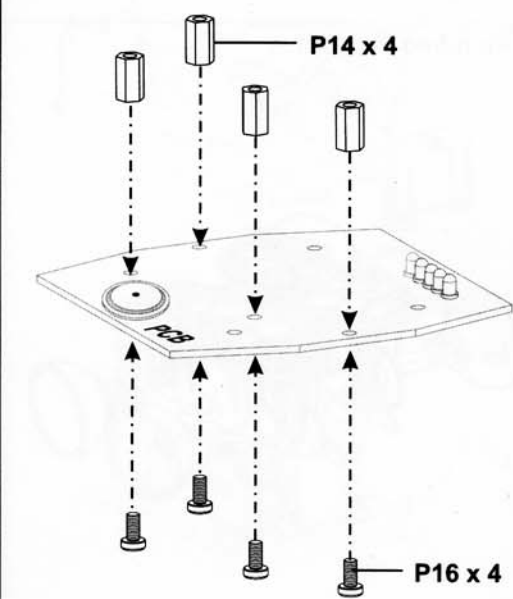

16

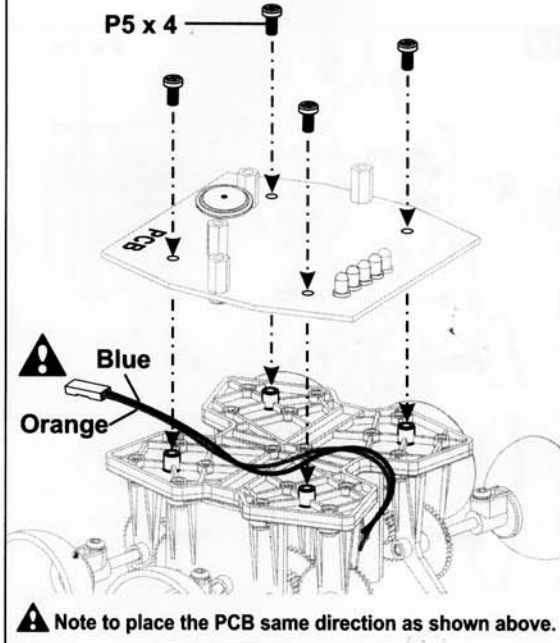

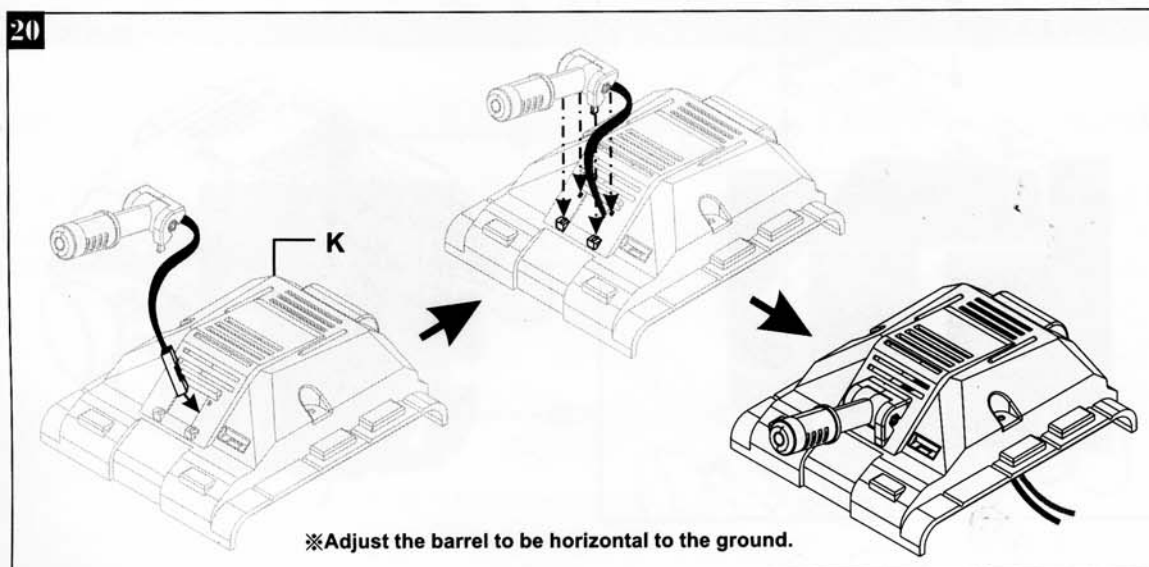
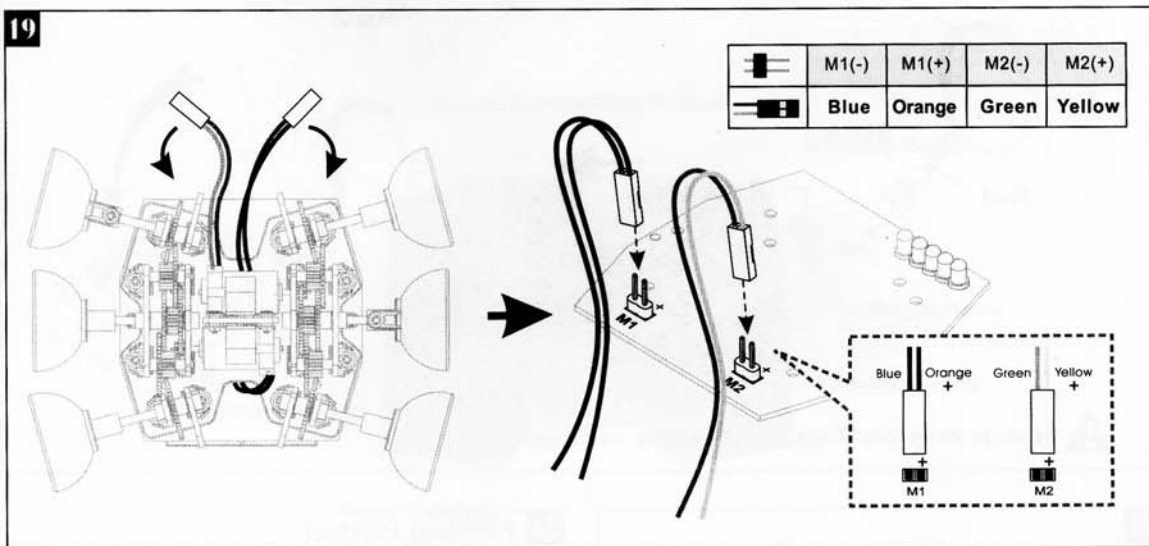
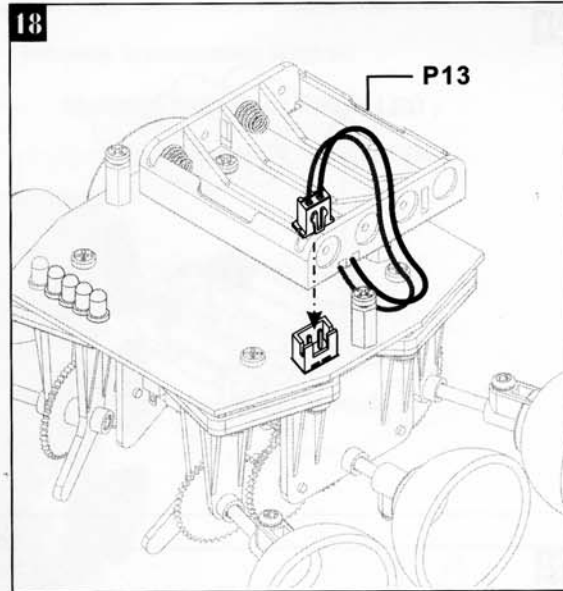
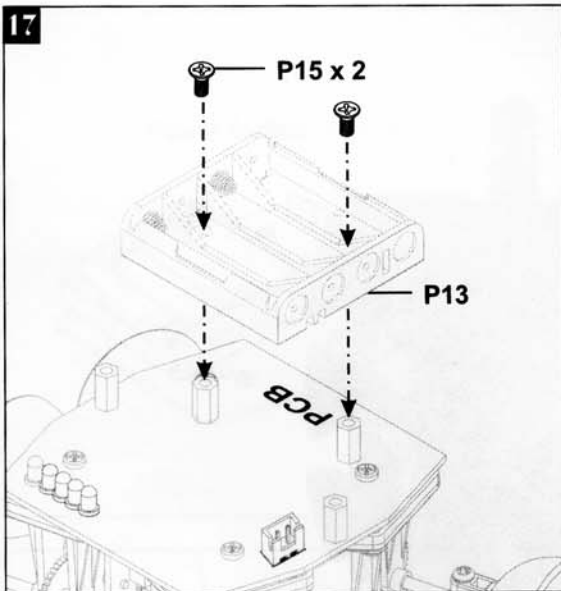

21

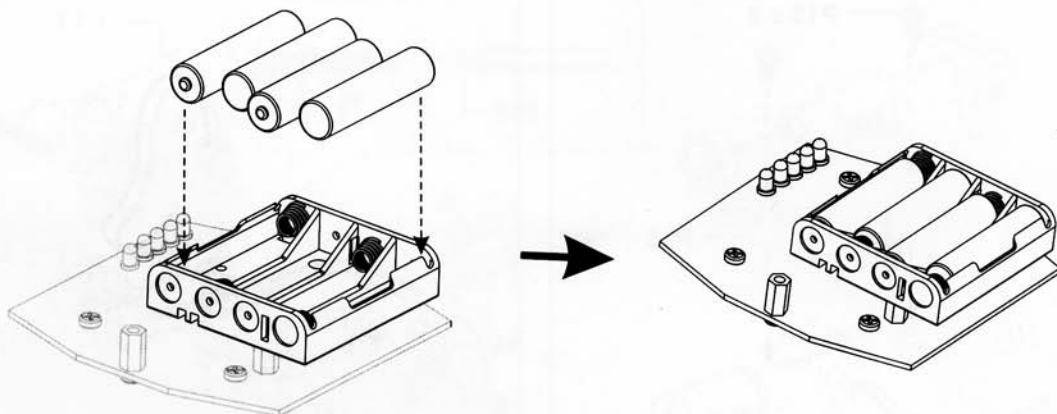

22

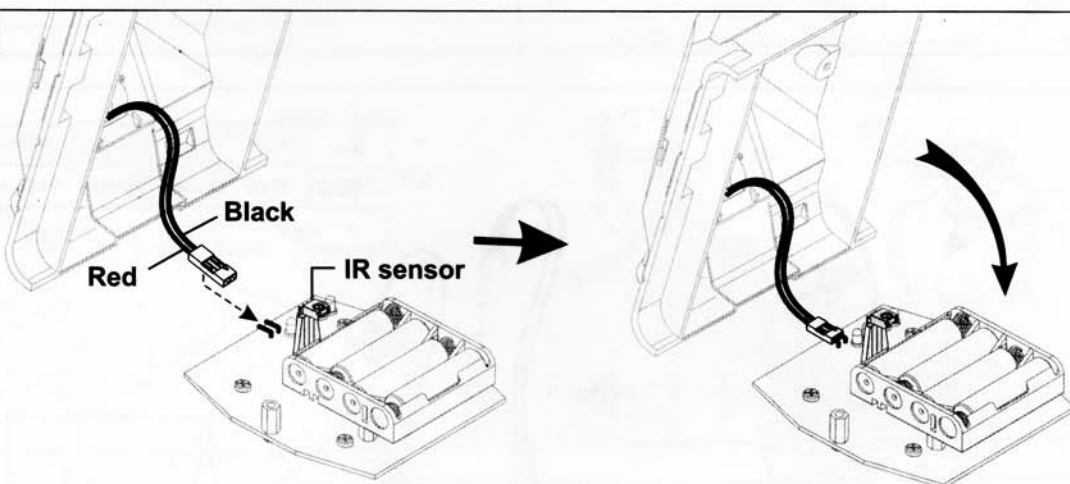

**⚠ Note to keep the IR sensor 90 degree as shown above.**

23

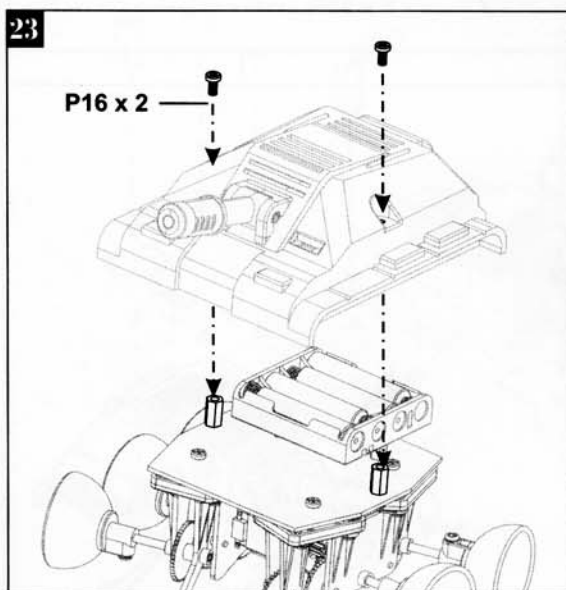

24 Finished Product

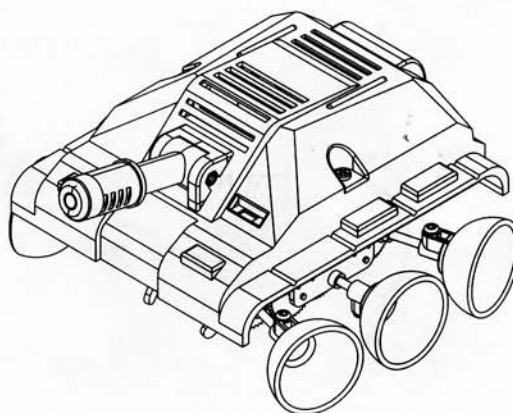

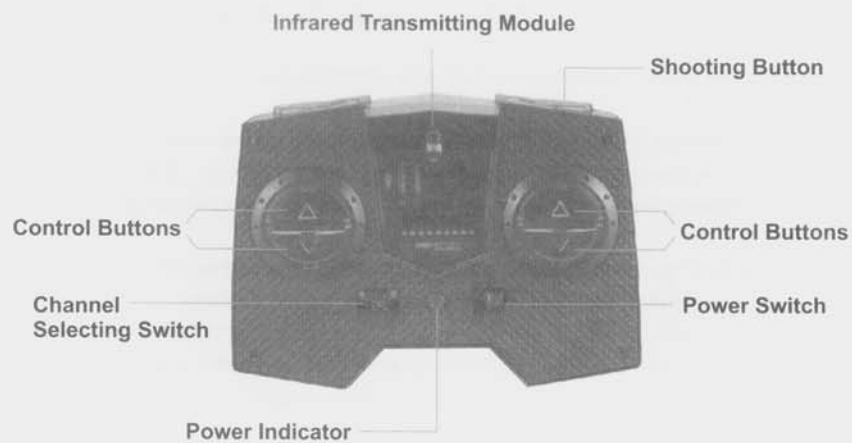
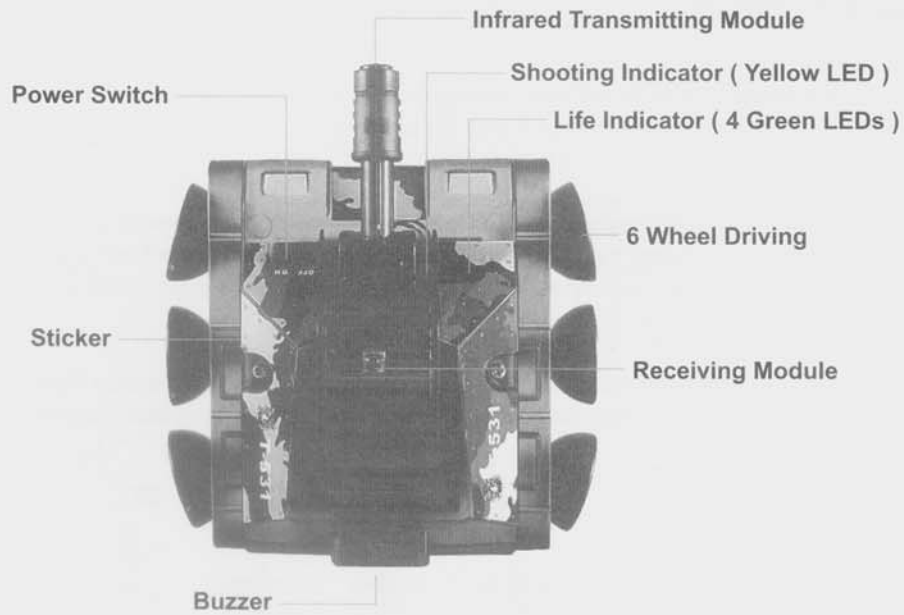

## 6.Decoration:

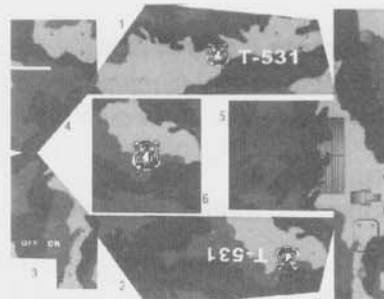
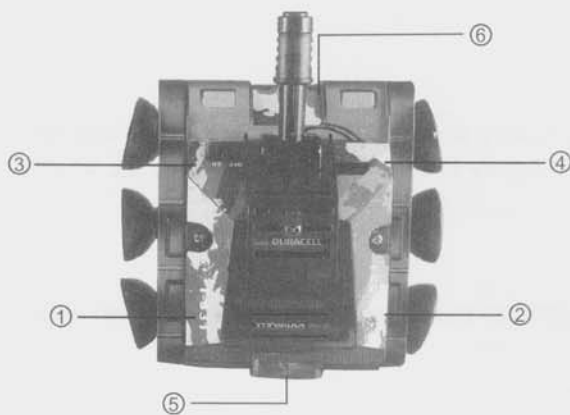

## 7. How it works:

### 1.I/R Remote Control Box:

Select the channel first by sliding the left-hand switch to A, B, C or D. Then turn the power switch on, the red LED will light. (The channel won't be changed once the power is on.)

### 2.Titan Tank:

a)The Titan Tank built in receiver module and it will learn the channel from the remote controller. Turn the power on. The red LED will light, then point the Remote Controller direct to the Titan Tank. Push any button of the remote controller for 3 to 5 seconds. When the buzzer beeps and 4 green LEDs light sequentially, the channel has been set up.

b)The Titan Tank has 8 different movements. See below chart, you can try to control the Titan Tank moves toward the way you want by pushing the control buttons on the remote controller. Practice it more, you will be familiar soon.

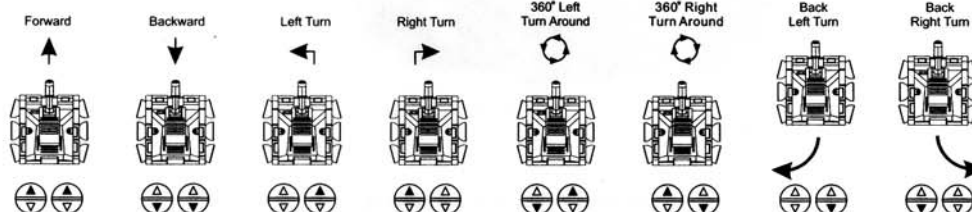

c)The Titan Tank needs to learn the channel from remote controller every time once you turn the power on.

d)If there are 2 or more players (maximum for 4), please note to set up the channels one by one. Make sure the other Titan Tanks are power off when anyone is setting up the channel. But if the Titan Tanks have learned the channel already, leave the power on, it won't learn another channel again.

e)There is a delay time for 2 seconds between each shoot. When the yellow LED is lighting, it is ready to shoot. Push the shooting button the Titan will make shooting sound and kick.

f)If Titan is shot by others, one of the green LED will become dark and turn 2 circles, after that, it is ready to combat again. When Titan is shot 4 times (all 4 green LEDs are dark), it keeps turning and makes ambulance sound. Turn the power off and play again.

g)To reset a different channel, both the remote controller and the Titan Tank need to turn the power off, then follow the step 1 & 2 a) again.

## 8. Trouble shooting:

### 1.I/R Remote Control Box:

**Check if the battery terminals are contacting properly to the PCB, also check if the batteries are inserted correctly. Make sure the PCB screwed tightly to the case (Refer to figure 4 on page 3).**

### 2. Titan Tank:

a) **Ensure all wirings are correct.**

b) **If it can not shoot others, check the wiring (IR-TX) from barrel to the PCB is not reversed. (Refer to figure 21 on page 12)**

c) **Adjust the barrel to the proper angle of shooting. Suggest to be horizontal to the ground.**



### 9. Circuit Diagram:

