

GUARDIAN ANGEL USER MANUAL

INTRODUCTION

Guardian Angel is a digital wireless device designed to protect the family. One Base can control up to four Tags. The MAX search range is 500 meters (1600 feet) in line of sight. There are three "Alarm Distance Modes" for each Tag from near, middle or far from the base. Once the tag is out of the set range, both units can trigger an alarm at 95 dB Level. A dis-alarm function is available to turn-off alarm function as desired. The tags can be attached to children, pets, cellular phones or any valuable objects. The panic button on the tag can be used to call the base if necessary. Guardian Angel is a CE and FCC compliance device.

OVERVIEW

Base Unit

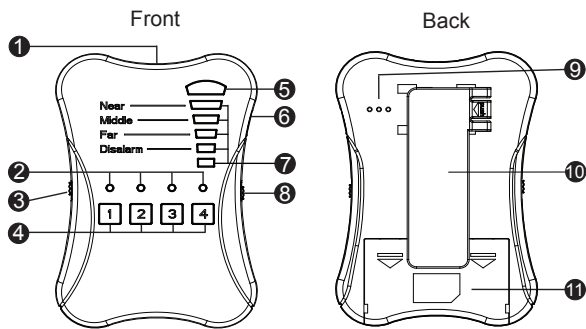

1	Strap attachment	
2	Connecting status	Show the signal synchronous status between Base and Tag unit
3	Power switch	Power on/off
4	Search button	Press to search for each Tag unit.
5	Direction indicator	Green LED lights light when selected Tag has been located
6	Setting button	Set desired functions for each tag
7	Signal strength	Signal strength
8	Mute button	Mute ON/OFF
9	Speaker	Sound output
10	Clip	
11	Battery cover	

Tag Unit

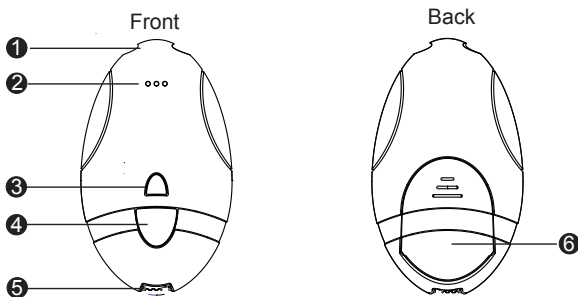

1	Ring attachment	
2	Speaker	Sound output
3	Connecting status	Show the signal synchronous status between Base and Tag unit
4	Panic button	Call the Base unit
5	Power switch	Power ON/OFF
6	Battery cover	

SPECIFICATION

Model Name	807G (1 to 1)		807G4 (1 to 4)	
Function	Search & Alarm		Search & Alarm	
Search Range	0~500m/1600ft		0~500m/1600ft	
Alarm Distance	Near : 10±5m/32±16ft Middle : 20±10m/64±32ft Far : 50±20m/160±64ft		Near : 10±5m/32±16ft Middle : 20±10m/64±32ft Far : 50±20m/160±64ft	
Base Unit / Tag Unit	Base (M07)x1	Tag (S08A)x1	Base (M07)x1	Tag (S08A)x4
Battery Type	AAA x 2	CR2032	AAA x 2	CR2032
Battery Life Time with Standby	90 days (8 hrs)	30 days (8 hrs)	90 days (8 hrs)	30 days (8 hrs)
Beep Sound (at 10cm/3.9inch)	95 db	95 db	95 db	95 db
Vibration	Vibration Motor	None	Vibration Motor	None
Dimension (L/W/H)	95x65x18mm 3.74x2.56x0.71inch	61.5x36x11.6mm 2.42x1.42x0.46inch	95x65x18mm 3.74x2.56x0.71inch	61.5x36x11.6mm 2.42x1.42x0.46inch

PACKAGE CONTENTS

Model Name	807G	807G4
Base Unit	1 pc	1 pc
Tag Unit	1 pc	4 pc
Batteries	AAAx2 CR2032x1	AAAx2 CR2032x4
Strap	1	1
Safety Pin	1	4
User manual	✓	✓

SUGGESTED SETTING PLACE

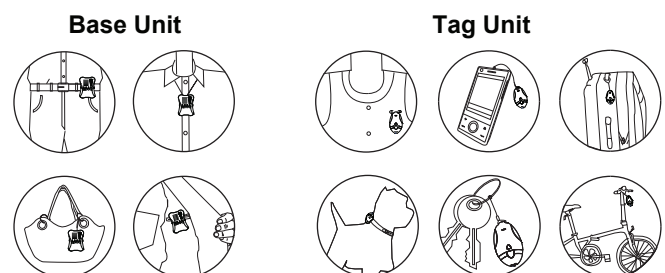

GUARDIAN ANGEL USER MANUAL

GETTING START

1. Insert the batteries into the Base unit and the Tag unit in according to the battery installation instruction as follows.

- Base unit

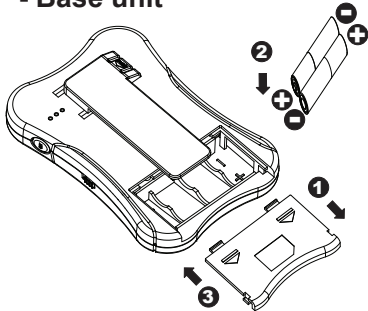

- Tag unit

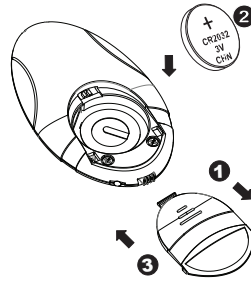

- Slide out the battery cover.
- Insert batteries (included) following the polarity markings in the battery compartment.
- Close the battery compartment cover as shown.

- Switch the power button of Base unit and Tag unit to "ON", and it will enter "Search Mode". Please press search button to enter "Standby mode".
- Place the Tag unit onto your child, pet, car, key, cellphone, bike, bag, etc. and take the Base unit with you or clip it on your belt.

SEARCH MODE - FIND A MISLAID ITEM

- Once you press the "Search button" specific to the Tag unit you are searching, the signal strength LEDs on the Base unit, which indicates distance, will start to blink.
- After you press the search button, hold the base unit and scan area slowly from right to left 360° and right and left again to allow the Base unit to calibrate. Any green LED lighting during this calibration period does not indicate Tag unit directionality.
- After allowing the Base unit to calibrate, slowly scan the unit once more from right to left and look for the green LED to light. When the green LED light, step forward in the direction indicated by the green light. The Base unit melody will increase in frequency and more red LEDs will be lit if you are proceeding in the correct direction. If the Base melody slows, the red LEDs light less frequently, or you lose the green LED signal, stop, and recalibrate the Base unit again according to step 2.
- When the all 5 Base unit red LEDs are lit, indicating the Tag unit is near, turn the Base unit mute button to OFF so the Tag unit melody can be heard. Continue to follow the Base unit green LED lights until the Tag unit is found and reached.
- Once the Tag unit is found, press the search button again on the Base unit to stop the search.

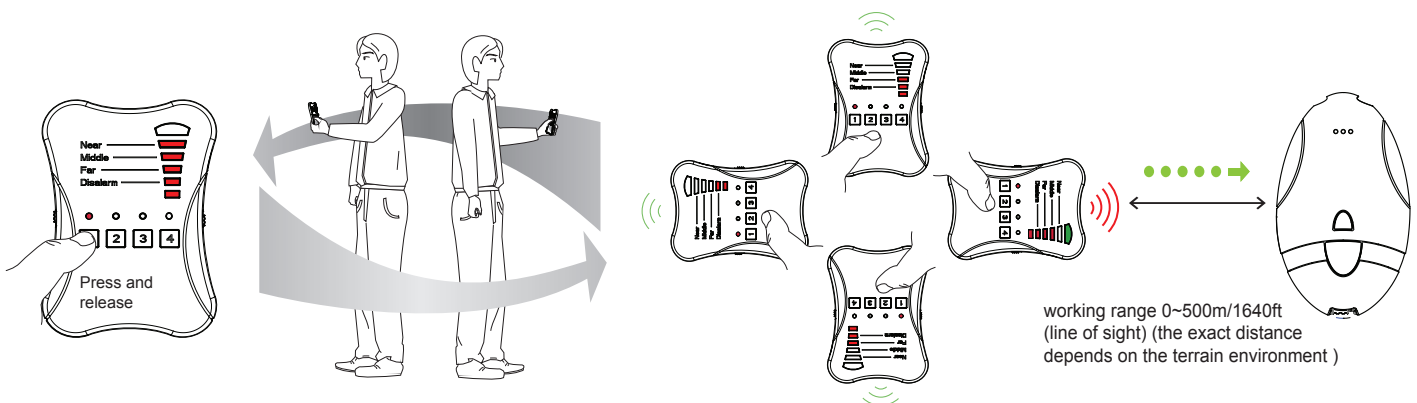

Search Tip:

- Place the Tag on a surface and practice locating a few times to get a feel for how it works.
- If you are ever unsure which direction to go in, slowly repeat full 360° circle and then go in the direction with the strongest signal strength.
- Guardian Angel might experience interference & loss of signal in crowded location such as shopping mall, amusement park. It is important to teach kids to go to an open area and stay there until their parents show up.
- While searching, always place the Base unit in front of your chest and turn around your body slowly to find the correct direction. If you point at the correct direction, the direction indication will be lit.
- If the distance between the Base unit and the Tag unit is out of detectable range, the Base unit and Tag unit beeps every second to remind you.
- If no signal is displayed, try moving position to a different area.

GUARDIAN ANGEL USER MANUAL

ALERT MODE - Prevent Items From Lost

When the Base unit alarms and vibrates, it means that distance between the Base unit and the Tag unit is out of range (Near, Middle, Far) of the set Tag unit range. The alert function can be disabled by setting the Base unit to the dis-alarm mode.

How to change the safety range (Default in Middle), example for Tag 1:

1. Hold the setting button. Red light for Tag unit 1 and the zone it is set in will flash.
2. If you would like to change the zone (Near, Middle, Far) setting, press the search button for Tag 1 and change the safety range to the desired range.
3. Repeat this process for Tag 2, 3 and 4 if you have multiple Tags.

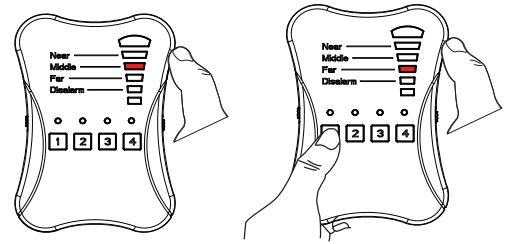

ACTIVATING PANIC ALERT

Tag provides the additional function of enabling a child or dependent in need to activate an alert alarm to call for help. To activate the Panic alarm, simply press and hold the panic button on the Tag and the Base unit will vibrate and alarm to which Tag has activated the Panic alarm.

MUTE MODE

When Base unit is near the searched tag (all 5 LED lit up), turn the Base unit mute switch to OFF so the Tag unit melody can be heard. Continue to follow the Base unit green LED lights until the Tag unit is found.

For search in a quiet environment: Set Base unit mute switch to OFF position before entering the search function. Base and Tag units will turn-off alarm and enter the silent search mode.

STANDBY MODE/SLEEP MODE

- a.) After switching the Base unit and Tag unit to power on, the Base unit will enter the linking process. The connecting status LED blinks while the Base unit is linking with the Tag unit in 5~10 seconds. If the Tag unit is within working range and NOT being blocked and the Tag unit has been linked up, the Base and Tag units will enter the standby mode.
- b.) In initialized phase: If the Base unit cannot link with the Tag unit due to out of range, blocked signal, or powered off Tag, it will enter sleep mode and continue to re-try to link the Tag unit. When user has found an unlinked tag (do not blink every second), user can push the Search key to enter the link-up process instantly.
- c.) When Base and Tags are linked, they will go to standby mode and connecting status LED will blink every second to show real-time linking activities.

Long Battery life Suggestion: When units are not in use, please turn off the Base and Tag units to conserve the battery life.

OUT OF RANGE (LOSS SIGNAL)

- a.) When devices are out of range or in the lost signal condition, the Base unit beeps, vibrates and signal LED blinks for 10 seconds. The Tag unit beeps for 15 seconds. The Base unit enters the sleep mode automatically and continues to try to link to the Tag unit.
- b.) Press the Search button on the Base unit to enter the linking-up process.

LOW BATTERY

When the Base unit or Tag unit is under low battery condition, it will beep every 2 minutes. Please change the battery immediately.

Important: Under low battery condition, it may cause abnormal function of alarm or searching.

REGISTER TAGS

All devices are registered before shipped; following procedure is just for your information.

Example for registering Tag 2.

1. To avoid the registration failure, make sure all Tag units and Base unit are powered off.
2. Press the setting button and search button 2 together. While still pressing the setting button and search button 2, turn the power on the Base unit.
3. Keep pressing the setting button and search button 2 and wait for the red light above the search button 2 to flash twice before releasing both buttons.
4. If you have successfully entered the registration mode for Tag 2, the light above search button 2 and below the dis-alarm light on the Base unit will be flashing together.
5. Place the unregistered Tag unit close to the Base unit (no more than 3" or 10 cm away) and turn the Tag unit on.
6. If registration was successful, the Base unit will beep once you have turned on the Tag unit.
7. If you need to register Tag 3 and 4, repeat steps 1-6 for each Tag.

Important: The register process must follow the order from 1 to 4.

GUARDIAN ANGEL USER MANUAL

FREQUENT ASKED QUESTIONS

Q. During searching mode: Why does the Base unit show more than one directions?

A. In search mode, the system collects and compares the signal strength to determine direction.

Sometimes signals from different directions have similar signal strength and may cause the Base unit to show more than one direction. This normally happens when the Tag unit is already very close to the Base unit and both units are in an enclosed environment, which causes signal reflection. If the signal strength LED tells you that you are already very close to the Tag unit the easiest way to fix this problem is to mute the Base unit and track the beeping sound from the Tag unit to locate missing items.

Q. Why did I get wrong direction? When I followed the direction indicator from base unit

A. This is also caused by the reflection of the signal. Sometimes, the signal from the correct direction has been weakened by signal blocker(s), but the signal from a wrong direction has been amplified by combining several wrong reflection signals (from multi sources; like metal wire fences..). To solve this wrong direction issue, you have to follow the direction indicator and move forward a few more steps. Once both status LED lights turn off for over 1 second, you know you are moving toward a wrong direction. You can restart your search for correct direction again then.

Q. What can cause false range alarm?

A. False alarms are caused by following reasons:

1. Both Base and Tag unit are too close to each other.
2. Low battery power will cause unpredictable behaviors.
3. Unit has been placed in a pocket with a lot of other material.

Q. Why is range alarm distance not consistent?

A. Because radio signal strength and signal reflection are affected by the environment. Users may need to adjust range to compensate for environment factors.

CARE AND MAINTENANCE

a). Search, detection, and alarm range depend on the terrain environment.

b). If the beep sound is not loud enough, the batteries may be low. Change with new batteries for louder alarm sound.

c). If you want to use the device during flight trips, please comply with the flight safety law according to each country.

d). The signal will be disconnected if the Base unit and Tag units are within 10 cm from each other (the signal connection will be overloaded). When the Base unit can't connect to Tag unit, the Base unit alarms every second and Tag unit's LED light flashes.

d). We reserve the right in changing the specification of the hardware and software designs to manuals at any time and without prior notice. Information in this document is subject to change without notice.

e). This product operational temperature is between 14 ~140 (-10°C~60°C). Storage Temperature is between -4 ~185 (-20°C~85°C).

Recycle: The Batteries provided in this product should be recycled to protect the local environment. Please contact your local recycle department for detail.

Warning: Do not put the batteries into the fire or heat sources. It may cause danger or even explosion.

FCC CERTIFICATIONS

Federal Communication Commission Interference Statement

This equipment has been tested and improved to comply with the limits of a Class B digital device, pursuant to Part 15 of the FCC Rules. These limits are designed to provide reasonable protection against harmful interference in a residential installation. This FCC Certifications equipment generates, uses and can radiate radio frequency energy, if installed and used not in accordance with the instructions, may cause harmful interference to radio communications. However, there is no guarantee that interference will not occur in a particular installation. If this equipment does cause harmful interference to radio or television reception, which can be determined by turning the equipment off and on, the user is encouraged to try to correct the interference by one of the following measures:

- Reorient or relocate the receiving antenna.
- Increase the separation between the equipment and receiver.
- Connect the equipment into an outlet on a circuit different from that to which the receiver is connected.
- Consult the dealer or an experienced radio/TV technician for help.

This device complies with Part 15 of the FCC Rules. Operation is subject to the following two conditions:

- (1) This device may not cause harmful interference, and
- (2) this device must accept an interference received, including interference that may cause undesired operation.

FCC Caution: Any changes or modifications are not expressly approved by the party responsible for compliance which could void the user's authority to operate this equipment.

