

图号 (Drawing NO.)	SG01 (20KAR) - 5Y006B - 000	型号 (Model No.)	SPG30E-20K	电压 (Voltage)
------------------	-----------------------------	----------------	------------	--------------

图纸 Drawing:	版次: 1.0	12V DC		
----------------	---------	--------	--	--

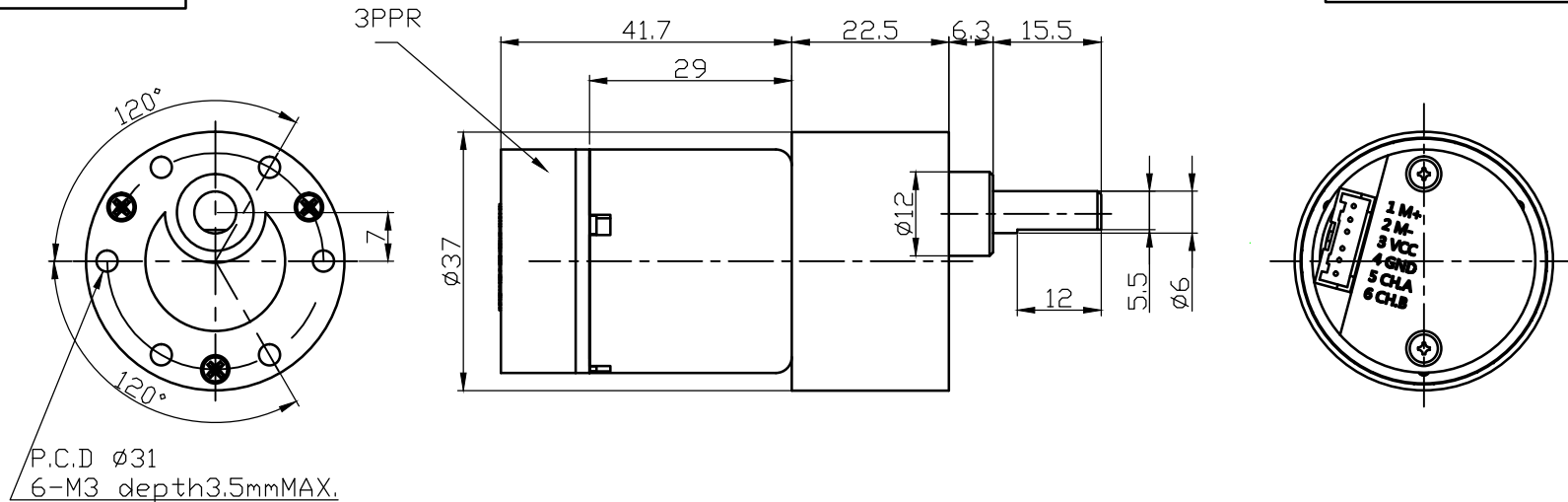

客户确认 (Customer APP.):

参数 Details:	减速电机参数 (Geared motor specification):		注意事项 (Notes):
	空载电流 (No Load Current) (mA):	≤ 90	
	空载转速 (No Load Speed) (r. p. m):	225 ± 22	
	额定力矩 (Rated Load Torque) (kgf. cm):	1.3	
	额定电流 (Rated Current) (mA):	≤ 570	
	额定转速 (Rated Load Speed) (r. p. m):	170 ± 17	
	堵转电流 (Stall Current) (mA):		
	堵转力矩 (Stall Torque) (kgf. cm):		
旋转方向 (Rotation Direction):	CW/CCW		

- 1, 焊接作业请在短时间内实行。(推荐: 焊接头的温度 $340 \sim 400^\circ\text{C}$, 2秒内实行) Please conduct the welding work in a short time. (Recommendation: With the soldering iron tip at a temperature of $340 \sim 400^\circ\text{C}$, within 2 seconds)
- 2, 在安装过程中不应使减速电机受到冲击、跌落。不允许直接在减速器出轴上敲打或压配。Prevent gear motor from being shocked or dropping in mounting process. It is prohibited to strike and crush directly on reducer output shaft.
- 3, 安装螺丝请先确认外观图所标示之形式及长度尺寸。Install the screws after first checking the taps and tap depth against the dimensions entered on the exterior drawing.
- 4, 请小心使用, 勿使黏接剂借由输出轴流入轴内。It is necessary to be careful that the adhesive does not spread along the shaft and flow into the bearing.
- 5, 请不要在安装零件时为了调整位置而从输出轴方向去回反转齿轮马达。Do not turn a geared motor by its output shaft when, for example, arranging its position so as to install it.

备注 (Remarks):

Draw:	Rev:	App.:
-------	------	-------