

G1- End Prosthetic Hand

Disassembly and Assembly Guide Manual V1.0

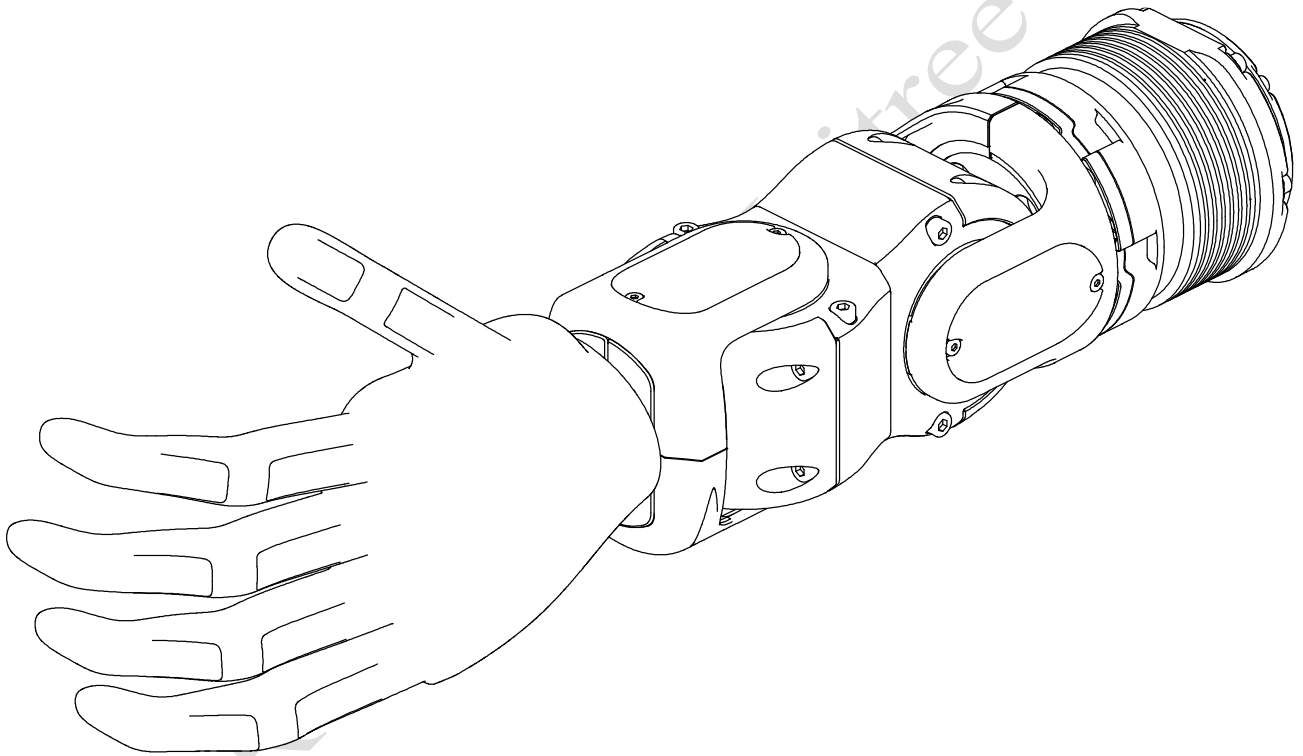

Unitree

This product is a civilian robot. We kindly request that all users refrain from making any dangerous modifications or using the robot in a hazardous manner.

Please visit [Unitree Robotics Website](https://www.unitree.com) for more related terms and policies, and comply with local laws and regulations.

Catalogue

| | |
|--|---|
| G1 Basic and Standard Versions..... | 2 |
| Disassembly Instructions..... | 2 |
| Step 1: Remove the hand clamp..... | 2 |
| Step 2: Remove the prosthetic hand..... | 2 |
| Installation Instructions..... | 3 |
| Step 1: Install the prosthetic hand..... | 3 |
| Step 2: Install the hand clamp..... | 3 |
| G1 Advanced and Flagship Versions..... | 4 |
| Disassembly Instructions..... | 4 |
| Step 1: Remove the cover plate..... | 4 |
| Step 2: Remove the clamp..... | 4 |
| Step 3: Remove the prosthetic hand..... | 5 |
| Installation Instructions..... | 5 |
| Step 1: Install the prosthetic hand..... | 5 |
| Step 2: Install the hand clamp..... | 5 |
| Step 3: Install the cover plate..... | 6 |
| Step 4: Complete the installation..... | 6 |

G1 Basic and Standard Versions

Disassembly Instructions

Step 1: Remove the hand clamp

Remove the six M3 screws (thread length 10mm) on the side of the hand, and take out the clamp, as shown in the following figure.

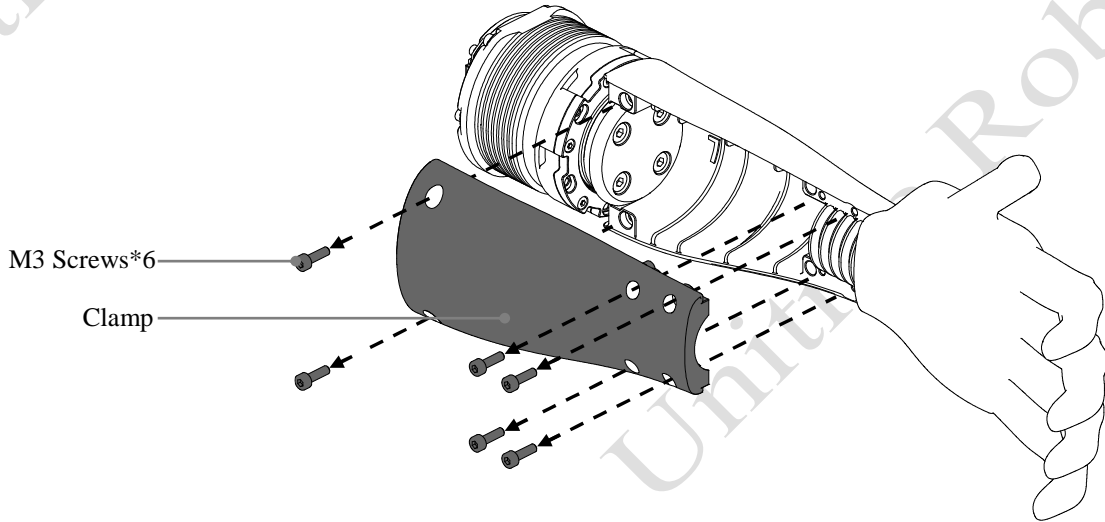

Step 2: Remove the prosthetic hand

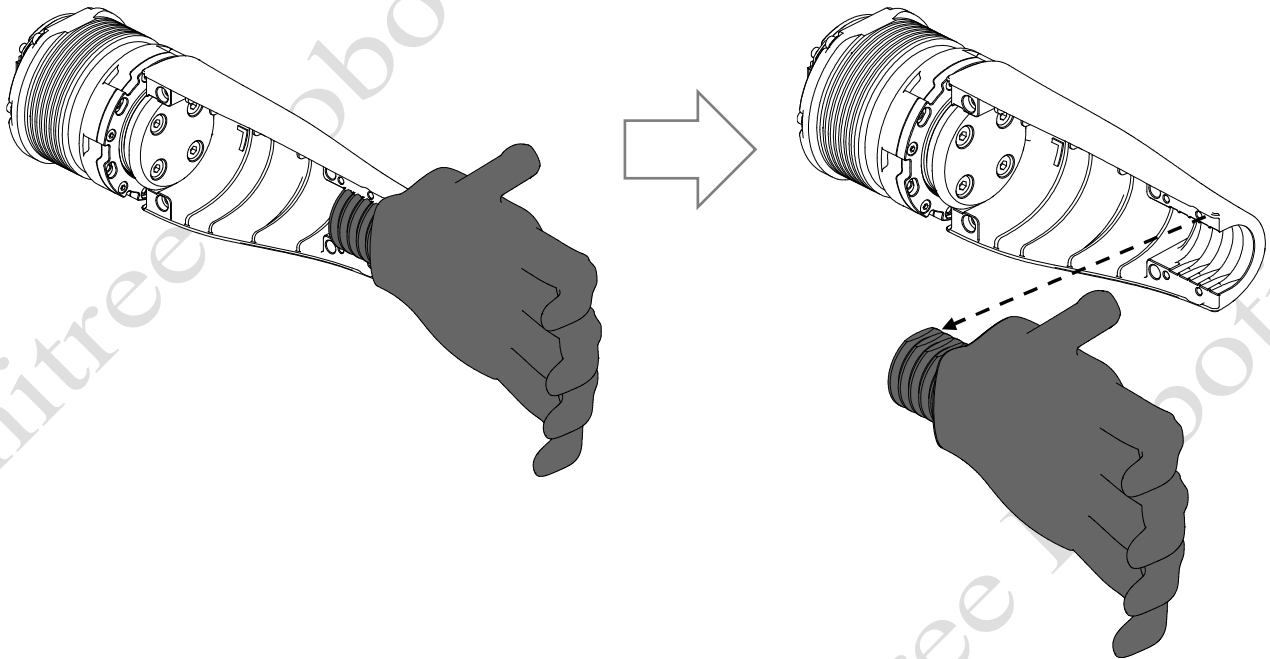

Installation Instructions

Step 1: Install the prosthetic hand

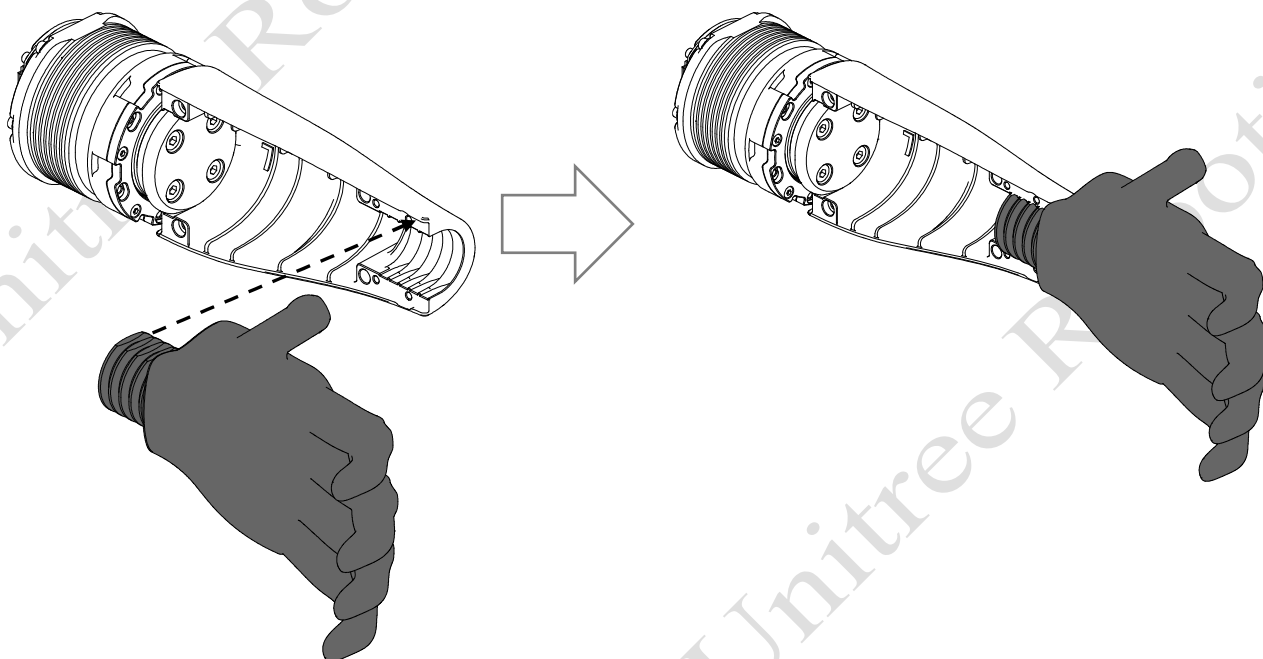

Step 2: Install the hand clamp

Put in the clamp and tighten the six M3 screws (thread length 10mm), as shown in the following figure.

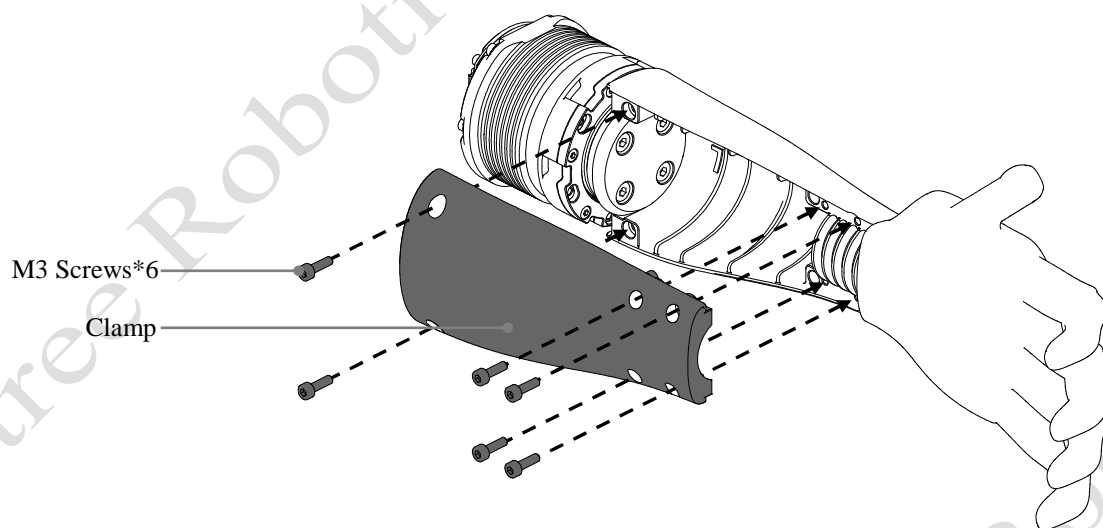

G1 Advanced and Flagship Versions

Disassembly Instructions

Step 1: Remove the cover plate

Remove the two M2 screws (thread length 5mm) and take out the cover plate, as shown in the following figure.

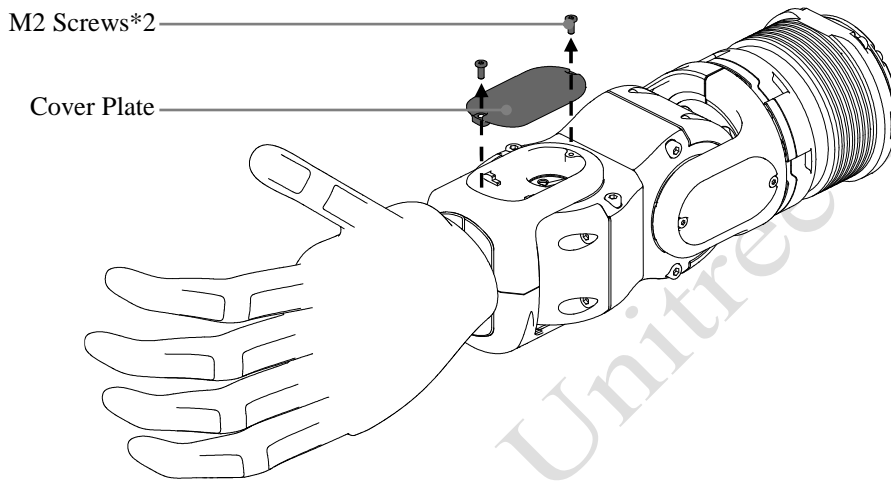

Step 2: Remove the clamp

Remove the two M3 screws (thread length 10mm), and take out the clamp (note to protect the cable), as shown in the following figure.

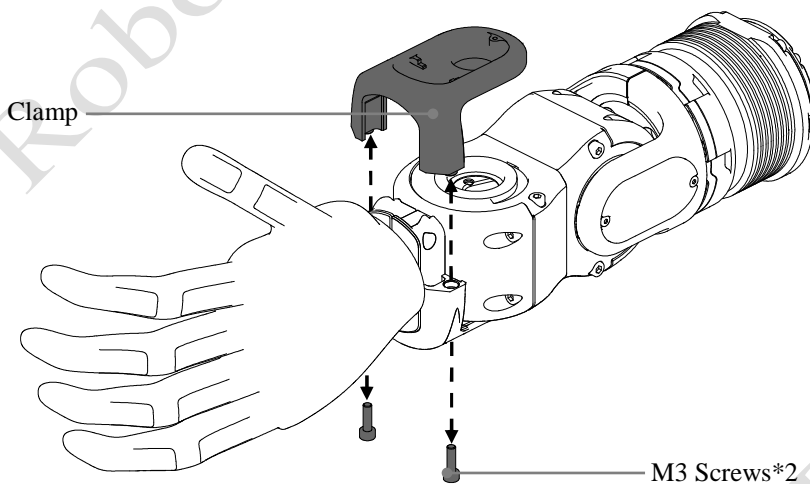

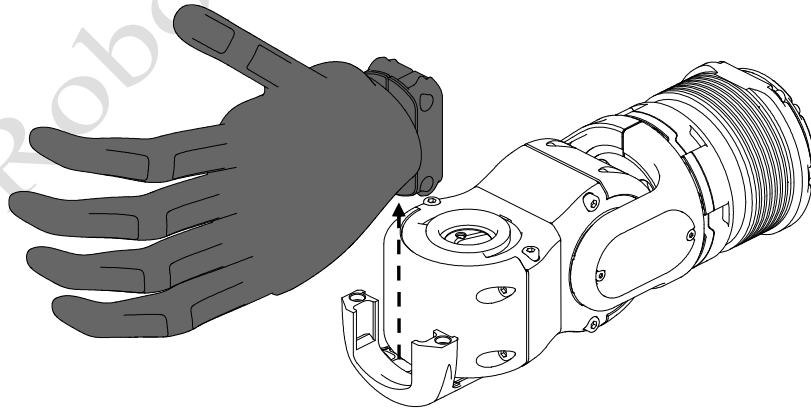
Step 3: Remove the prosthetic hand**Installation Instructions****Step 1: Install the prosthetic hand**

Put in the prosthetic hand (note to distinguish between the left and right prosthetic hands and the placement direction), as shown in the following figure.

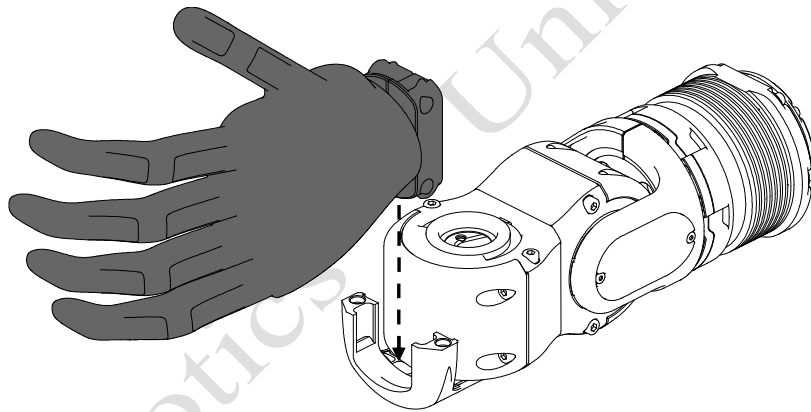
**Step 2: Install the hand clamp**

Put in the clamp (note to protect the cable) and tighten the two M3 screws (thread length 10mm), as shown in the following figure.

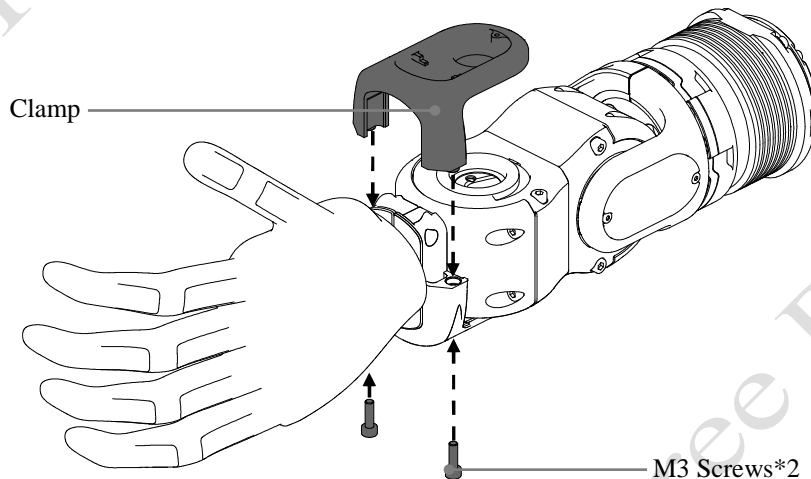

Step 3: Install the cover plate

Put in the cover plate (note to protect the cable) and tighten the two M2 screws (thread length 5mm), as shown in the following figure.

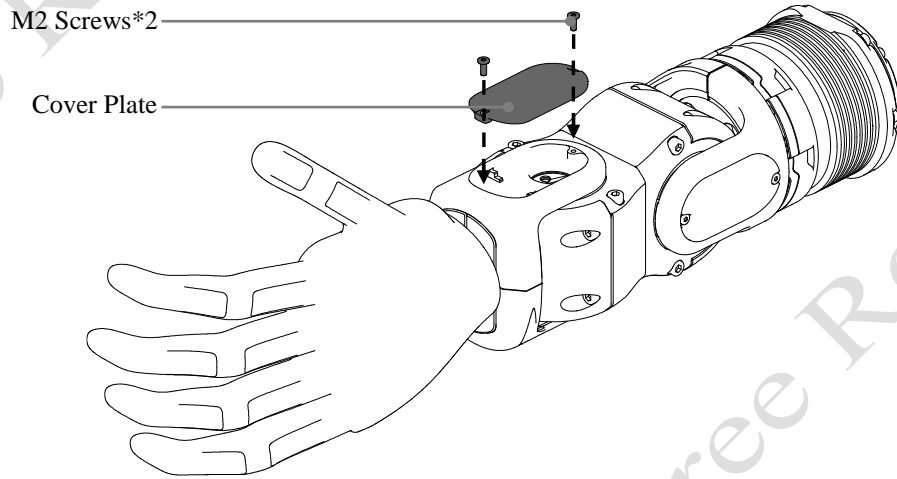

Step 4: Complete the installation

