

www.PuduRobotics.com

CC1 工作站 用户手册 ^(V1.0)

型号：SDBC01

版权所有 © 2023 深圳市普渡科技有限公司版权所有，保留所有权利。

未经深圳市普渡科技有限公司明确书面许可，任何单位或者个人不得擅自仿制、复制、誊抄或转译本说明书部分或者全部内容，且不得以营利为目的进行任何方式（电子、影印、录制等）的传播。本说明书所提到的产品规格和资讯仅供参考，如果内容更新，恕不另行通知。除非有特殊规定，本说明书仅作为使用指导，所作陈述均不构成任何形式的担保。

安全须知

1.1 使用须知

- 工作站的使用者应接受技术支持人员的专业培训。
- 工作站部署，可能涉及水路或电路轻量施工，需找专业人员实施。
- 工作站放置的位置应为常温的室内场景，禁止将工作站放置于高温区域（ $> 40^{\circ}\text{C}$ ）使用。
- 发现工作站损坏，充电电流异常，或加 / 排水异常，请停止使用工作站。
- 务必使用原厂专配的电源线，严禁使用非原厂电源线给工作站供电。
- 小心保护电源线，避免拉拽，扭曲。
- 严禁工作站与外物碰撞，造成工作站损坏。
- 请勿在易燃易爆物体附近使用工作站。
- 工作站出现冒烟、烧焦气味，表示工作站异常，请立即断开工作站电源，并联系普渡工作人员。
- 工作站使用时不能随意挪动位置，在指定的位置使用工作站。
- 本工作站只可搭配 CC1 使用，严禁使用本工作站给其他公司出品的产品使用。
- 严禁放置于阳光直射的区域存储或工作。
- 若工作站出现红灯异常时，请将机器人与工作站分开；等待工作站灯光变为绿色，便可重新使用。
- 若红灯长时间不熄灭，请联系技术支持人员。
- 如需使用自动添加清洁液功能，请选用无泡清洁剂。禁止强酸、强碱类等具有强腐蚀性的清洁剂。
- 水管接头处请务必拧紧。

1.2 环境须知

- 工作环境温度： $0^{\circ}\text{C} \sim 40^{\circ}\text{C}$ ，相对湿度： $\leq 90\%$ （ $<40^{\circ}\text{C}$ ）。
- 存储环境温度： $-20^{\circ}\text{C} \sim 70^{\circ}\text{C}$ ，相对湿度 $\leq 85\%$ ，存储1年。
- 工作环境要求：
 1. 需放置于平整的地面上，背靠平整墙面，通过侧向连接组件，与墙面或地面固定。（如下图所示）

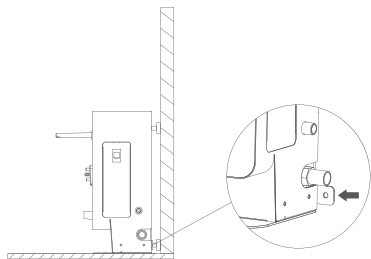

2. 工作站工作的位置无镜面或玻璃等反光或透光的部件，如不可避免，可能需要对环境进行一定程度的改造。
3. 充电桩周围不能有易燃物品。
4. 正常工作时，前方2米和左右方向1.5米内保持空旷无遮挡。

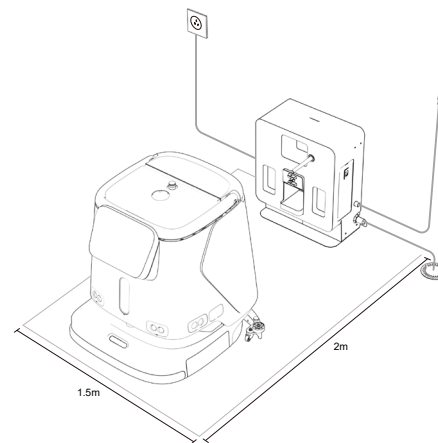

5. 清水水压在 $0.1\text{--}0.6\text{mpa}$ 。
6. 排污口高度距离地面不超过 0.5m 。（如下图所示）

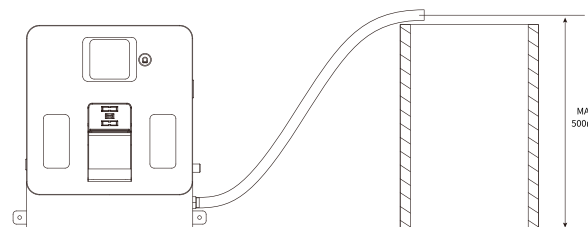

产品组成

2.1 包装清单

充电桩整机（不含电源适配器）×1、说明书×1、清水管×1、污水管×1。

2.2 外观介绍

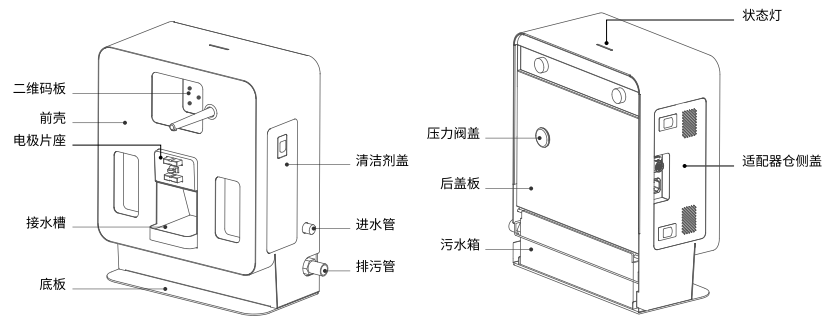

2.3 技术规格

产品特性	说明
产品名称	CC1 工作站
产品功能	支持机器人自动加排水、自动充电、自动注入清洁剂
整机尺寸	404mm x 274mm x 497mm
整机重量	20 kg
输入电压	90~264V AC
输出电压	DC24V
工作温度	0~40°C
工作湿度	≤ 90% (40°C)
存储温度	-20°C ~70°C
通信方式	蓝牙
安装要求	地面固定或背面靠墙固定
外部依赖	水源、地漏、电源

产品使用

3.1 使用说明

- 将进水管一端连接工作站进水口，另一端与清水水源连接；
- 将污水管一端连接工作站排水口，另一端置于排污处。

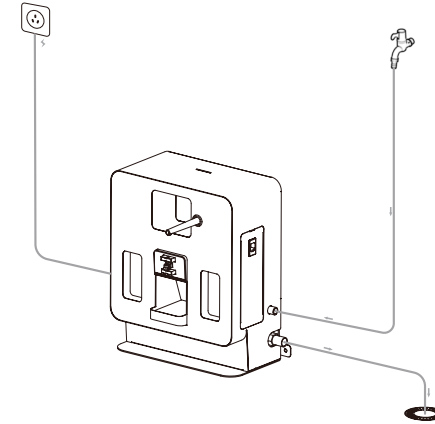

- 将前期已购入的 CC1 机器人充电适配器（不在工作站包装内），装进工作站内部（如下图示）。
- 工作站的外接电源线请使用 CC1 机器人附带的适配器电源线。

*安装时，注意电源适配器的散热孔朝下。

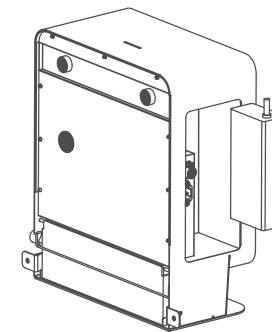

- 如需加入清洁剂，请将清洁剂容器取出，倒入清洁剂后放回工作站内（如下图示）。

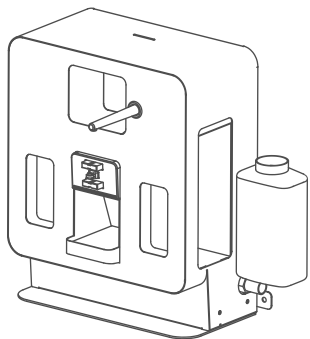

⚠ 注意：本工作站，仅支持使用无泡清洁剂，且禁止强酸、强碱性清洁剂加入。
设备转移时，请将容器内清洁剂清空。

- 可以使用贴纸固定工作站的位置从而更好实现与清洁整机的对桩（如下图示）。

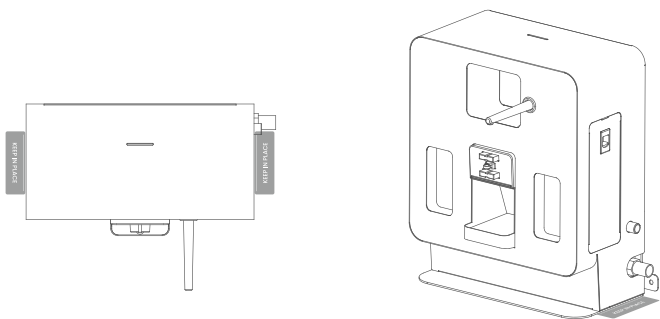

指示灯说明

状态	说明
红色闪烁	发生故障
绿色常亮	正常待机（非连接状态）
绿色闪烁	同机器人连接中
绿色呼吸	连接成功

维护与保养

- 工作站脏污、有灰尘，请使用柔软、干净的无尘布擦拭清洁。
- 定期清理工作站接污盘内脏污。
- 如工作站出现裂痕、变形、漏水、无法加排水、无法充电等情况，请断开电源，及时联系售后服务。

售后服务

4.1 免费保修服务

公司承诺符合以下情况，自产品收货之日起，在产品有效保修期内（产品的不同部件保修期限有所不同），符合如下情况的将提供免费的产品保修服务：

- 自购买产品在规定的产品保修期限内正常使用，出现非人为的质量问题；
- 无擅自拆机、无非官方说明书指引的改装或加装、其它非人为引起的故障；
- 产品序列号、出厂标签及其他标示无撕毁、涂改迹象；
- 提供有效的购买证明、单据及单号；
- 免费保修期内更换的损坏备件属公司所有，应按公司要求寄回。

4.2 保修范围外的售后服务

- 对于不在免费保修范围内的售后服务（超出保修期或者在保修期内不符合免费保修条款），公司提供收费售后服务；
- 自购买产品在规定的产品保修期限内正常使用，出现非人为的质量问题；
- 无擅自拆机、无非官方说明书指引的改装或加装、其它非人为引起的故障；
- 产品序列号、出厂标签及其他标示无撕毁、涂改迹象；
- 提供有效的购买证明、单据及单号；
- 免费保修期内更换的损坏备件属公司所有，应按公司要求寄回；
- 公司官方提供线上和远程技术支持渠道，客户需配合技术工程师进行问题诊断和故障处理；
- 经技术工程师诊断必须上门解决问题的，指派专业技术人员提供上门服务；
- 不在免费保修范围内的售后服务，需按照要求填写《售后服务记录表》；
- 服务费用包含：售后维护费用以及备件费用。

4.3 售后服务咨询

如果您有任何问题需要咨询，请联系普渡科技客服热线：400-0826-660。

普渡科技售后人员服务工作时间是：每周一至周六，上午 9:30 至 12:00，下午 13:30 至 18:30

Copyright © 2023 Shenzhen Pudu Technology Co., Ltd. All rights reserved.

No organization or individual shall imitate, copy, transcribe or translate the contents of this user manual, in part or in full, without the express written consent of Shenzhen Pudu Technology Co., Ltd., or distribute this user manual for profit in anyway (electronically or via photocopying, recording, etc.). The product specifications and information provided in this user manual are for reference only and are subject to change without further notice. Unless otherwise specified, this user manual is only intended as a user guide, and no representation shall be deemed as a warranty of any kind.

Safety Instructions

1.1 Instructions for use

- workstation users should receive professional training from technical support personnel.
- Deployment of workstations may involve lightweight construction of waterways or circuits, so professionals are required to implement
- The workstation should be placed in an indoor scene with normal temperature. It is forbidden to place the workstation in a high temperature area ($> 40^{\circ}\text{C}$) for use
- If the workstation is damaged, the charging current is abnormal, or the charging/draining is abnormal, please stop using the workstation.
- Be sure to use the original power cord, and it is strictly forbidden to use non-original power cords to supply power to the workstation.
- Carefully protect the power cord to avoid pulling and twisting.
- It is strictly forbidden for the workstation to collide with foreign objects, causing damage to the workstation.
- Do not use the workstation near flammable and explosive objects.
- If the workstation emits smoke or burnt smell, it means that the workstation is abnormal. Please disconnect the power supply of the workstation immediately and contact Purdue staff.
- Do not move the workstation arbitrarily when in use, and use the workstation at the designated location.
- This workstation can only be used with CC1, and it is strictly forbidden to use this workstation for products produced by other companies.
- It is strictly forbidden to store or work in areas exposed to direct sunlight.
- If there is an abnormal red light on the workstation, please separate the robot from the workstation. Wait for the workstation light to turn green before it can be used again;
- If the red light does not go off for a long time, please contact technical support personnel.
- If you need to use the function of automatically adding cleaning solution, please use non-foaming cleaning agent. Prohibit the use of strong corrosive cleaning agents such as strong acid and strong alkali
- Be sure to tighten the water pipe joint.
- This appliance can be used by children aged from 8 years and above and persons with reduced physical, sensory or mental capabilities or lack of experience and knowledge if they have been given supervision or instruction concerning use of the appliance in a safe way and understand the hazards involved. Children shall not play with the appliance. Cleaning and user maintenance shall not be made by children without supervision.

- Children should be supervised to ensure that they do not play with the appliance.
- Warning against recharging non-rechargeable batteries
- SAVE THESE INSTRUCTIONS - This manual contains important safety and operating instructions for battery charger Models SDBC01.
- Before using battery charger, read all instructions and cautionary markings on battery charger, battery, and product using battery
- CAUTION - To reduce risk of injury, charge only Li-ion type rechargeable batteries ((DC 25.6V, Max.50Ah). Other types of batteries may burst causing personal injury and damage.

1.2 Environmental Notice

- Working environment temperature: $0^{\circ}\text{C} \sim 40^{\circ}\text{C}$, relative humidity: $\leq 90\%$ ($< 40^{\circ}\text{C}$).
- Storage ambient temperature: $-20^{\circ}\text{C} \sim 70^{\circ}\text{C}$, relative humidity $\leq 85\%$, storage for 1 year.
- Working environment requirements:
 1. The workstation needs to be placed on a flat ground for use, with its back against a flat wall, and fixed to the wall or the ground through lateral connection components.

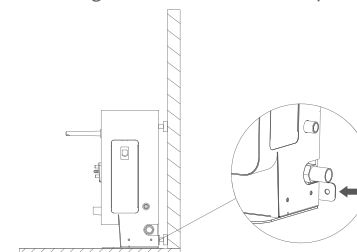

2. There are no reflective or light-transmitting parts such as mirrors or glass in the working position of the workstation. If it is unavoidable, the environment may need to be modified to a certain extent.
3. There should be no flammable objects around the charging pile.
4. During normal operation, keep open and unobstructed within 2 meters in front and 1.5 meters in the left and right directions.

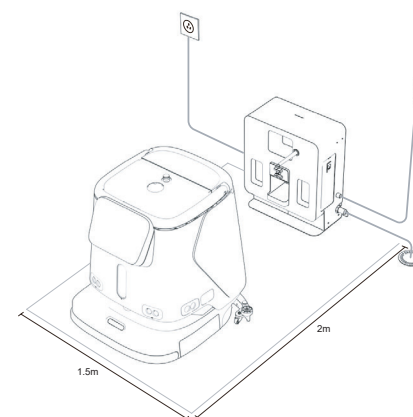

5. The pressure of clean water is 0.1-0.6mpa.
6. The height of the sewage outlet is not more than 0.5m from the ground.

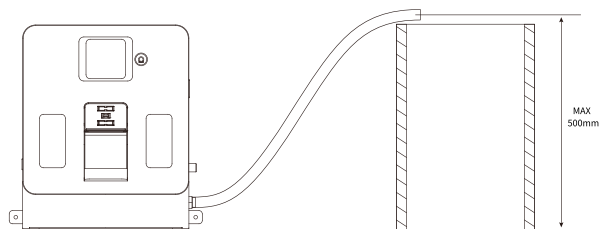

Product introduction

2.1 Packing list

Charging pile machine (excluding power adapter) × 1, power cord × 1, instruction manual × 1, clean water pipe × 1, sewage pipe × 1.

2.2 Appearance introduction

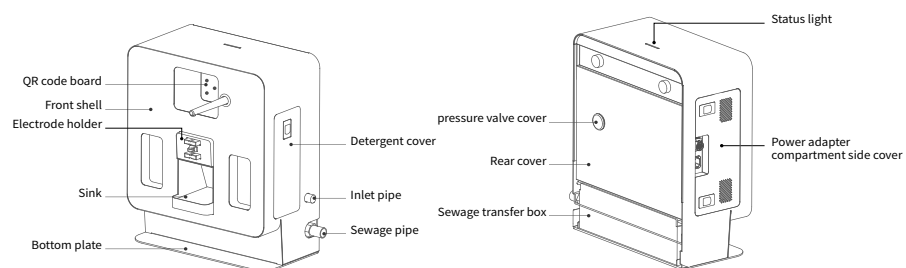

2.3 Performance parameters

Product Characteristics	Description
Product Name	CC1 Docking Station
Product function	Support robot automatic adding and draining, automatic charging, automatic injection of cleaning agent
Body size	404mm x 274mm x 497mm (L, W, H)
Body weight	20 kg
Input voltage	90~264V AC
Output voltage	DC24V
Working temperature	0~40°C
Working humidity	≤ 90% (40°C)
Storage temperature	-20°C ~70°C
Communication method	Bluetooth
Installation requirements	Ground fixed or back against the wall fixed
External dependencies	External dependencies Water source, floor drain, power supply

Product use

3.1 Instructions for use

- Connect one end of the water inlet pipe to the water inlet of the workstation, and the other end to the clean water source;
- Connect one end of the sewage pipe to the drainage outlet of the workstation, and place the other end at the sewage discharge place. (as shown below)

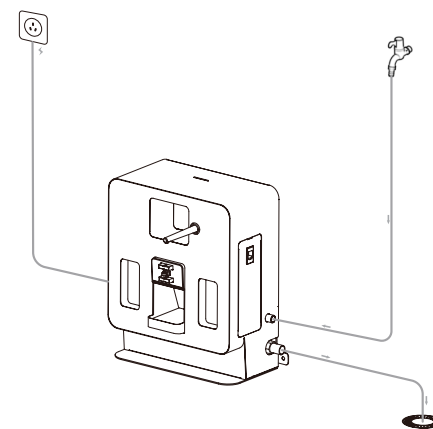

- Put the CC1 robot charging adapter (not in the workstation package) purchased earlier into the workstation(*When installing, pay attention to the heat dissipation hole of the power adapter facing down).

For the external power cord of the workstation, please use the adapter power cord attached to the CC1 robot.

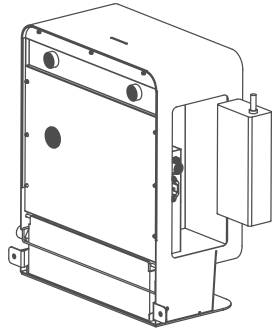

- If you need to add cleaning solution, please take out the cleaning solution container, pour the cleaning solution and put it back into the workstation .(as shown below)

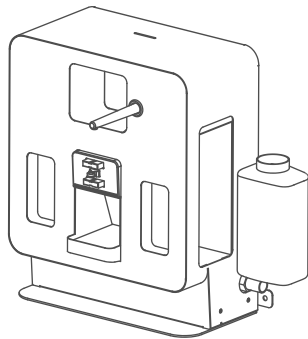

⚠ Attention: This workstation only supports the use of non-foaming cleaners, and strong acid and strong alkaline cleaners are prohibited.
When the equipment is transferred, please empty the cleaning agent in the container.

- Stickers can be used to fix the position of the workstation so as to better achieve alignment with the cleaning machine (as shown below)

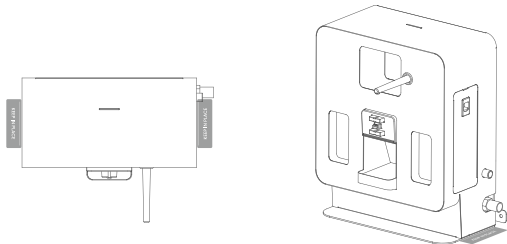

Indicator light description

Indicator Light	Description Light Status
Flashing red	Fault occurred
Steady green	Normal standby (non-connected state)
Flashing green	Blinking blue
Breath green	Connection successful

Maintenance

- The workstation is dirty and dusty, please use a soft, clean, lint-free cloth to wipe it clean.
- Regularly clean the dirt in the dirt tray of the workstation.
- In case of cracks, deformation, water leakage, inability to add drainage, inability to charge the workstation, etc., please disconnect the power supply and contact the after-sales service in time.

After sales service

4.1 Free warranty service

The company promises to meet the following conditions, from the date of product receipt, within the effective warranty period of the product (the warranty period of different parts of the product is different),Free product warranty service will be provided if the following conditions are met:

- Since the purchased product is used normally within the specified product warranty period, there are non-artificial quality problems;
- No unauthorized disassembly, no modification or installation not guided by the official manual, and other non-human failures;
- The product serial number, factory label and other marks are not torn or altered;
- Provide valid proof of purchase, receipt and order number;
- Damaged spare parts replaced during the free warranty period belong to the company and should be sent back as required by the company.

4.2 After-sales service beyond the scope of warranty

- For after-sales service that is not within the scope of free warranty (beyond the warranty period or does not meet the terms of free warranty within the warranty period), the company provides paid after-sales service;

- The company officially provides online and remote technical support channels, and customers need to cooperate with technical engineers for problem diagnosis and troubleshooting;
- If it is necessary to come to the door to solve the problem after the diagnosis of the technical engineer, assign a professional technician to provide the door-to-door service;
- For after-sales service that is not within the scope of free warranty, you need to fill in the "After-sales Service Record Form" as required;
- Service fee includes: after-sales maintenance fee and spare parts fee.

4.3 After-sales service consultation

If you have any questions,
please contact Purdue Technology customer service hotline: +86 755-86952935.
Email: techservice@pudutech.com