



XR Headset Mount

Easily add the world's best hand tracking to your headset with the XR Headset Mount for the Leap Motion Controller 2. The Mount's uniquely flexible design provides a secure fit to the face of the most popular XR headsets.



Easy to integrate and use

- Provides a downward tilt angle of 15°, maximizing the interaction area in which users hold their hands.
- Conforming back provides a secure fit to the face of XR headsets with flat faces and to those that are most curved.
- The Mount can be fitted to some of the most popular headsets on the market, including but not limited to: Pico 4 Enterprise, Pico Neo 3 Pro and Pro Eye, Pico G3, HTC Vive Focus 3, Varjo Aero. Don't see your headset? Contact Ultraleap.
- The Mount includes a 22 cm, Right Angled USB C cable to allow users to easily connect their Leap Motion Controller 2 to the accessory port of their XR headset.

Specifications

Dimensions:	96.5 mm x 23.5 mm x 20.4 mm
Tilt angle:	15°
Material:	PA2200 Polyamide 12 (Nylon 12)
Mount Adhesive:	Reusable Nano Tape
USB Cable Spec:	Right Angle USB C – Right Angle USB C, USB 3.0 22 cm length

Mount dimensions

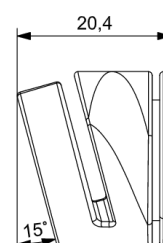
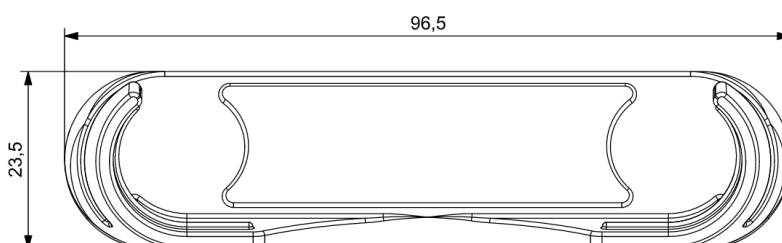

All dimensions in mm